



# COVE Meeting

CITIZENS' CONSTRUCTION OVERSIGHT AND VALUE ENGINEERING

April 18, 2024

# COVE

## Meeting Agenda

---

Thursday, April 18, 2024  
8:00 a.m. – 10:00 a.m.

### 1. Call to Order and Approval of Meeting Minutes

- Chair Comments – Pat Knipe
- Approval of March 21, 2024 Meeting Minutes

### 2. Review Action Items

- None

### 3. Department Reports

- Capital Funding Update – Doreen Concolino
- Master Schedule Update – Basem Ghneim / Michael Singh
- Project Budget Update – Basem Ghneim / Michael Singh
- Project Status Report – Craig Jackson
- Change Order Report – Ed Ames / Basem Ghneim

### 4. Presentations

- Sales Tax Referendum Statutes and Language – Jad Brewer
- Facilities Board Workshop Preview – Basem Ghneim

### 5. Discussion and Adjournment

- Next COVE meeting scheduled on Thursday, May 16, 2024

---

The Construction Oversight and Value Engineering Committee monthly meeting convened on Thursday, March 21, 2024 at 8:00 a.m., at the John T. Morris Facilities Complex, located at 6501 Magic Way, building 200, Orlando, Florida 32809, and virtually through Cisco WebEx.

### **ATTENDEES**

**COVE Members:** Jacki Churchill, Michael Denny, Jeff Hart, Douglas Kelly, Pat Knipe and Sarah Taylor.

**OCPS Team:** Mary Lu Bronson, Steve Compton, Doreen Concolino, Eric Dolhon, Amy Envall, Craig Jackson, Linda Lindsey, Lori Orr, Judith Padres, Tonya Page-Batson, Rory Salimbene, Rocco Williams, Karin Williamson and Mike Winter.

**Program Management Team:** Basem Ghneim, Toni Greene, Mark O'Connor, Michael Singh and Bill Terry.

---

### **1. CALL TO ORDER**

A quorum was established and Chairman Pat Knipe called the meeting to order at 8:05 a.m.

#### Chair Comments

Pat Knipe stated that Amy Envall would be sitting in on behalf of Jad Brewer.

#### Approval of Minutes from Last Meeting

The minutes from February 15, 2024 were presented, and approved unanimously by the committee.

### **2. ACTION ITEMS**

- a. Provide the de minimis review presentation at a future COVE meeting.
- b. Provide information on Artificial Intelligence (AI), 3-D Printing and the Lego-like block system at a future COVE meeting.

#### Review of Action Items from Previous Meeting

- a. None.

### **3. DEPARTMENT REPORTS**

#### Capital Funding Update

Judith Padres provided a handout and offered information on the *Cash Optimization* plan (see attached).

Also, she provided the *updates for capital funding, sales tax collections and impact fee collections*, listed on pages 14-16 and stated we have received six months of impact fee collections from the City of Orlando, two quarters from the county, and two months from the City of Apopka.

In addition, she reviewed the status of the *Sales Tax Referendum Projects and Expenditures*, listed on pages 17-22, and completed her update with a review of projects funded through other sources, listed on pages 23-26.

#### Master Schedule Update

Basem Ghneim briefed the committee on the *master schedule* on page 28, and stated the Board has approved the purchase of site 97-E-SE-2 in the Weewahootee area.

Also, there are resolutions for time extensions scheduled for the April 2, 2024 board meeting, for Orange Technical College East (site 512-T-E-1) and Orange Technical College West (site 73-T-W-7) campuses.

### Project Budget Update

Michael Singh began his review of the *capital project report* for new and replacement schools on page 30. There are currently 11 projects, spanning phases for planning, design and construction totaling \$690M. There were no budget changes to report.

Next, Michael referenced page 31 of the report and noted there were 28 comprehensive projects spanning the phases of planning, design and construction amounting to \$1.59B. There were no budget changes to report.

Michael continued with the *capital renewal update* on pages 32-34, where there are 63 active projects at 121 sites showing a budget of \$457M. Two projects were added: Audubon Park School (\$604,000) and the FY24 Multi-site Cooling Tower Refurbishment (\$3,315,000). No other budget changes were reported.

Lastly, Michael reviewed the *capital renewal forecast* on page 36, and cited a fund balance of \$721.9M.

### Project Status Report

Craig Jackson reviewed the *capital and comprehensive needs* projects currently under construction, noting there are 11 projects in construction (four comprehensive, four relief and three replacements). Additionally, there are currently 15 projects in planning and 12 projects in design.

- *Jeff Hart asked what the current footprint (acreage) is for the schools, and for the team to bring back information for building on a 5-acre site.*

Rory Salimbene stated the current planned acreage is typically 15-acres, and information would be provided at a future meeting.

Craig ended his report by stating there are currently 63 capital renewal projects in construction at 121 sites (36 large, 19 intermediate and eight small).

### Change Order Report

Tonya Page-Batson on behalf of Ed Ames, reported the data for the month of January 2024, and stated there were no significant change orders for the reporting period.

- *On page 61, item 1, Jeff Hart questioned the additional design services for \$150,000.*

Basem stated the added design services were mostly mechanical, and remain in design.

- *On page 62, item 2, Jeff Hart questioned the time extension needed to install new sinks.*

Basem stated they needed to be done to comply with the National Emission Standards for Hazardous Air Pollutants (NSHAP).

To conclude the report, Tonya mentioned there were two RFQs for the month of February 2024.

## **4. PRESENTATIONS**

### Life Cycle Cost Analysis: Luxury Vinyl Tile (LVT) vs. Vinyl Composition Tile (VCT)

Basem Ghneim provided the Life Cycle Cost Analysis for Luxury Vinyl Tile (LVT) vs. Vinyl Composition Tile (VCT) which included the 50-Year Life Cycle Cost per square foot and Flooring Operational Costs (*see attached*).

### Sales Tax Timeline

Rory Salimbene presented the next steps for the Sales Tax Referendum, and Amy Envall offered legal guidance regarding the ballot language (*see attached*).

**5. DISCUSSION / ADJOURNMENT**

Chairman Pat Knipe stated the next COVE meeting was scheduled for April 18, 2024.

Pat mentioned he would like a follow-up on 1) the effect AI (artificial intelligence) is having within the workplace, 2) new information regarding the use of 3-D Printing and 3) utilization of the Lego-like blocks.

The chairman thanked everyone for their participation in today's meeting, and commented on the importance of the presentations and how they were very much appreciated and needed.

**The meeting was adjourned at 10:00 a.m.**

**Minutes Authenticated by:**

---

**Pat Knipe**  
Chairperson, COVE Committee

---

Date of approval

---

**Jad Brewer**  
Legal Services, Facilities

---

Date of approval

**Attachments:**

Cash Optimization plan  
Life Cycle Cost Analysis  
Sales Tax Timeline



# Cash Optimization

March 21, 2024

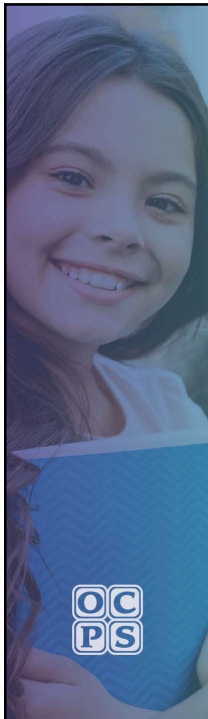

## Three current options to refund debt:

- **Tax-Exempt Current Refunding:** Wait out the call protection period and, if market conditions permit, execute a current refunding not more than 90 days before the bonds become subject to optional redemption
- **Taxable Advance Refunding:** If market conditions permit, execute an advance refunding using taxable bonds
- **Cash Optimization:** Utilize cash on hand to defease (pay off) outstanding bonds and fund new money capital projects with tax-exempt bonds (versus a bond-funded taxable refunding transaction or waiting until a current tax-exempt refunding)



## Overview of Cash Optimization

- Cash optimization involves a re-allocation of capital to take advantage of municipal borrowing rates and taxable investment yields
- Existing pay-as-you-go capital funds are used to defease outstanding debt instead of issuing refunding bonds
- New money capital projects are funded with a tax-exempt new money debt issuance



3

## Overview of Cash Optimization, cont.

- Depending on interest rates, the economics of cash optimization can match or even exceed the benefits of a traditional refunding
- In optimal conditions, new money debt service will be less than the debt service of the defeased bonds, generating aggregate debt service savings
- Current market conditions suggest that we can generate savings by using the cash optimization option



4





## Life Cycle Cost Analysis (VCT vs. LVT)

50 Year Life Cycle Cost Per SF	VCT	LVT
Initial Construction Costs	\$2.45	\$5.23
Repair/ Replacement Costs (over 50 years) - Year 10 Repairs - Year 20 Repairs - Year 25 Replacement - Year 35 Repairs - Year 45 Repairs	\$2.95	\$6.30
Operation/ Maintenance Costs (over 50 years)	\$166.86	\$145.80
<b>Total Cost / S.F.</b>	<b>\$172.26</b>	<b>\$157.33</b>

1

## Flooring Operational Costs

Hard Surface Cleaning	Frequency	VCT	LVT
Entries and Door Mats	Daily	✓	✓
Dust Mop	Daily	✓	✓
Wet Mop	3 Times Weekly	✓	✓
Deep Clean	2 Times Annually	✓	✓
Spray Buff (Burnish)	2 Times Annually	✓	
Scrub and Recoat	2 Times Annually	✓	
Strip/Refinish	2 Times Annually	✓	
<b>Cost / S.F. / year</b>		<b>\$ 3.34</b>	<b>\$ 2.92</b>

2

# Sales Tax Referendum Next Steps

- Gather schools and community input on facility needs via ThoughtExchange January/February 2024
- Update enrollment projections, capital improvement plan and budget needs for new schools and capacity enhancement April 2024
- Update comprehensive and capital renewal needs forecast April 2024
- Review updated needs forecast with COVE April 18, 2024
- Facilities update to Board/Board budget priorities May 7, 2024
- Final adoption of resolution and ballot language by the Board May 28, 2024
- Approval of referendum by Board of County Commissioners June 4, 2024
- Ballot language (English & Spanish) to Supervisor of Elections June 14, 2024
- Referendum on General Election ballot November 5, 2024



**CAPITAL FUNDING UPDATE**

**FY2024 Sales Tax Forecast Compared To Collections  
For Collections Received For The Period June 1, 2023 - May 31, 2024**

	Fiscal Year 2019 Actual Collections	Fiscal Year 2020 Actual Collections	Fiscal Year 2021 Actual Collections	Fiscal Year 2022 Actual Collections	Fiscal Year 2023 Actual Collections	Fiscal Year 2024 Projected Collections	Fiscal Year 2024 Actual Collections	Date Received	Actual vs Projection				Actual vs Prior Year			
									Difference Monthly	% Difference Monthly	Difference Year To Date	% Difference Year To Date	Difference With Prior Year	% Difference With Prior Year	Cum Difference With Prior Year	% Cum Difference With Prior Year
									<b>June</b>	21,813,615	22,925,741	13,108,514	23,848,325	28,818,745	24,933,405	28,368,958
<b>July</b>	20,771,709	21,966,783	13,655,914	23,820,627	26,552,569	24,271,373	26,949,604	9/27/2023	2,678,231	11.03%	6,113,784	12.43%	397,035	1.50%	(52,752)	-0.10%
<b>August</b>	19,375,685	20,607,144	13,689,148	20,150,373	25,312,864	22,422,764	24,992,029	10/26/2023	2,569,265	11.46%	8,683,049	12.12%	(320,834)	-1.27%	(373,587)	-0.46%
<b>Quarter - Distribution</b>	3,260,952	3,338,214	4,014,607	5,620,309	7,333,106	6,432,030	7,252,252	11/6/2023	820,222	12.75%	9,503,271	12.17%	(80,853)	-1.10%	(454,440)	-0.52%
<b>Quarter - Total</b>	<b>65,221,961</b>	<b>68,837,881</b>	<b>44,468,184</b>	<b>73,439,633</b>	<b>88,017,283</b>	<b>78,059,572</b>	<b>87,562,843</b>				<b>9,503,271</b>	<b>12.17%</b>			<b>(454,440)</b>	<b>-0.52%</b>
<b>September</b>	20,029,499	20,695,054	15,713,676	21,896,095	25,711,154	24,002,925	26,984,726	11/27/2023	2,981,801	12.42%	12,485,072	12.23%	1,273,572	4.95%	819,132	0.72%
<b>October</b>	21,176,213	22,650,187	15,709,696	23,905,773	27,564,584	25,465,794	27,848,145	12/26/2023	2,382,351	9.36%	14,867,424	11.66%	283,561	1.03%	1,102,693	0.78%
<b>November</b>	21,848,770	23,121,776	16,337,370	25,794,011	27,841,619	26,524,510	28,285,348	1/29/2024	1,760,838	6.64%	16,628,262	10.79%	443,729	1.59%	1,546,422	0.91%
<b>Quarter - Distribution</b>	3,646,732	3,532,907	4,523,961	7,274,990	7,902,837	7,468,313	8,185,741	2/6/2024	717,428	9.61%	17,345,689	10.74%	282,904	3.58%	1,829,326	1.03%
<b>Quarter - Total</b>	<b>66,701,214</b>	<b>69,999,923</b>	<b>52,284,704</b>	<b>78,870,869</b>	<b>89,020,194</b>	<b>83,461,542</b>	<b>91,303,960</b>				<b>17,345,689</b>	<b>10.74%</b>			<b>1,829,326</b>	<b>1.03%</b>
<b>First 1/2 Year Total</b>	<b>131,923,175</b>	<b>138,837,805</b>	<b>96,752,888</b>	<b>152,310,502</b>	<b>177,037,477</b>	<b>161,521,114</b>	<b>178,866,803</b>				<b>17,345,689</b>	<b>10.74%</b>			<b>1,829,326</b>	<b>1.03%</b>
<b>December</b>	23,379,047	25,393,825	17,165,676	28,708,776	32,031,954	29,531,809	29,962,406	2/27/2024	430,597	1.46%	17,776,286	9.30%	(2,069,548)	-6.46%	(240,222)	-0.11%
<b>January</b>	21,073,611	23,118,851	15,817,302	23,523,330	27,182,532	25,216,789	27,514,419	3/27/2024	2,297,630	9.11%	20,073,916	9.28%	331,887	1.22%	91,665	0.04%
<b>February</b>	21,507,567	21,922,091	17,365,549	25,504,014	27,632,509	26,725,064	-		0	0.00%	-	0.00%	0	0.00%	-	0.00%
<b>Quarter - Distribution</b>	3,452,049	4,004,206	4,909,457	8,256,308	8,565,493	8,237,620	-		0	0.00%	-	0.00%	0	0.00%	-	0.00%
<b>Quarter - Total</b>	<b>69,412,273</b>	<b>74,438,972</b>	<b>55,257,984</b>	<b>85,992,429</b>	<b>95,412,488</b>	<b>89,711,282</b>	<b>57,476,825</b>				<b>-</b>	<b>0.00%</b>			<b>-</b>	<b>0.00%</b>
<b>3/4 Year Total</b>	<b>201,335,448</b>	<b>213,276,777</b>	<b>152,010,872</b>	<b>238,302,930</b>	<b>272,449,966</b>	<b>251,232,396</b>	<b>236,343,628</b>				<b>-</b>	<b>0.00%</b>			<b>-</b>	<b>0.00%</b>
<b>March</b>	25,501,978	16,298,832	23,660,893	31,317,507	31,873,069	32,922,594	-		0	0.00%	-	0.00%	0	0.00%	-	0.00%
<b>April</b>	22,737,566	9,524,264	21,512,382	28,431,166	29,167,856	29,988,585	-		0	0.00%	-	0.00%	0	0.00%	-	0.00%
<b>May</b>	21,730,575	11,135,296	21,709,815	27,010,484	27,202,256	28,779,795	-		0	0.00%	-	0.00%	0	0.00%	-	0.00%
<b>Quarter - Distribution</b>	3,151,332	3,730,011	4,753,904	7,350,019	7,597,320	7,468,106	-		0	0.00%	-	0.00%	0	0.00%	-	0.00%
<b>Quarter - Total</b>	<b>73,121,451</b>	<b>40,688,403</b>	<b>71,636,994</b>	<b>94,109,175</b>	<b>95,840,501</b>	<b>99,159,080</b>	<b>-</b>				<b>-</b>	<b>0.00%</b>			<b>-</b>	<b>0.00%</b>
<b>Second 1/2 Year Total</b>	<b>142,533,724</b>	<b>115,127,375</b>	<b>126,894,978</b>	<b>180,101,604</b>	<b>191,252,989</b>	<b>188,870,362</b>	<b>57,476,825</b>				<b>-</b>	<b>0.00%</b>			<b>-</b>	<b>0.00%</b>
<b>Annual Total</b>	<b>274,456,899</b>	<b>253,965,180</b>	<b>223,647,866</b>	<b>332,412,105</b>	<b>368,290,467</b>	<b>350,391,476</b>	<b>236,343,628</b>				<b>-</b>	<b>0.00%</b>			<b>-</b>	<b>0.00%</b>

## Orange County Public Schools Sales Tax Collection History

Fiscal Year	Amount
2003	48,842,740
2004	138,701,456
2005	149,353,778
2006	166,421,562
2007	170,597,436
2008	166,190,269
2009	154,176,278
2010	150,843,957
2011	163,594,345
2012	170,826,444
2013	181,301,579
2014	191,770,163
2015	209,540,613
2016	224,024,409
2017	233,873,477
2018	257,649,248
2019	274,456,899
2020	253,965,180
2021	223,647,866
2022	332,412,105
2023	368,290,467
2024	236,343,628 *
<b>Total</b>	<b>4,466,823,897</b>

\* Amount collected thru January 2024

## Impact Fees Collections

	FY19	FY20	FY21	FY22	FY23	FY24
July	(1,356,434)	(791,922)	(15,459)	(1,326,589)	0	(6,775,236)
August	1,544,905	1,642,692	3,021,080	2,198,714	651,853	10,226,811
September	4,802,716	6,418,111	4,902,480	282,676	1,211,965	88,664
October	12,782,279	5,018,829	11,324,673	15,541,805	18,406,599	15,251,741
November	764,538	11,783,397	744,321	3,824,286	626,571	1,644,118
December	544,774	531,273	1,049,444	2,896,867	18,822	-
January	14,550,401	1,435,048	56,625	14,137,661	16,638,979	4,476,377
February	3,319,118	11,250,567	3,010,120	3,056,570	645,056	7,139,901
March	929,755	1,613,436	3,125,497	2,347,260	2,677,874	67,535
April	11,439,392	10,735,683	6,887,734	4,786,133	3,909,942	
May	674,261	2,027,236	5,720,199	16,810,116	25,302,244	
June	14,645,906	14,200,335	21,268,703	29,769,895	12,949,506	
<b>Total</b>	<b>64,641,613</b>	<b>65,864,685</b>	<b>61,095,416</b>	<b>94,325,395</b>	<b>83,039,410</b>	<b>32,119,911</b>

As of 4-5-24

**MASTER SCHEDULE UPDATE**



# Capital Program Schedule Summary

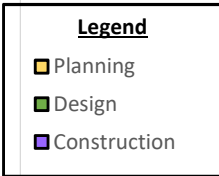
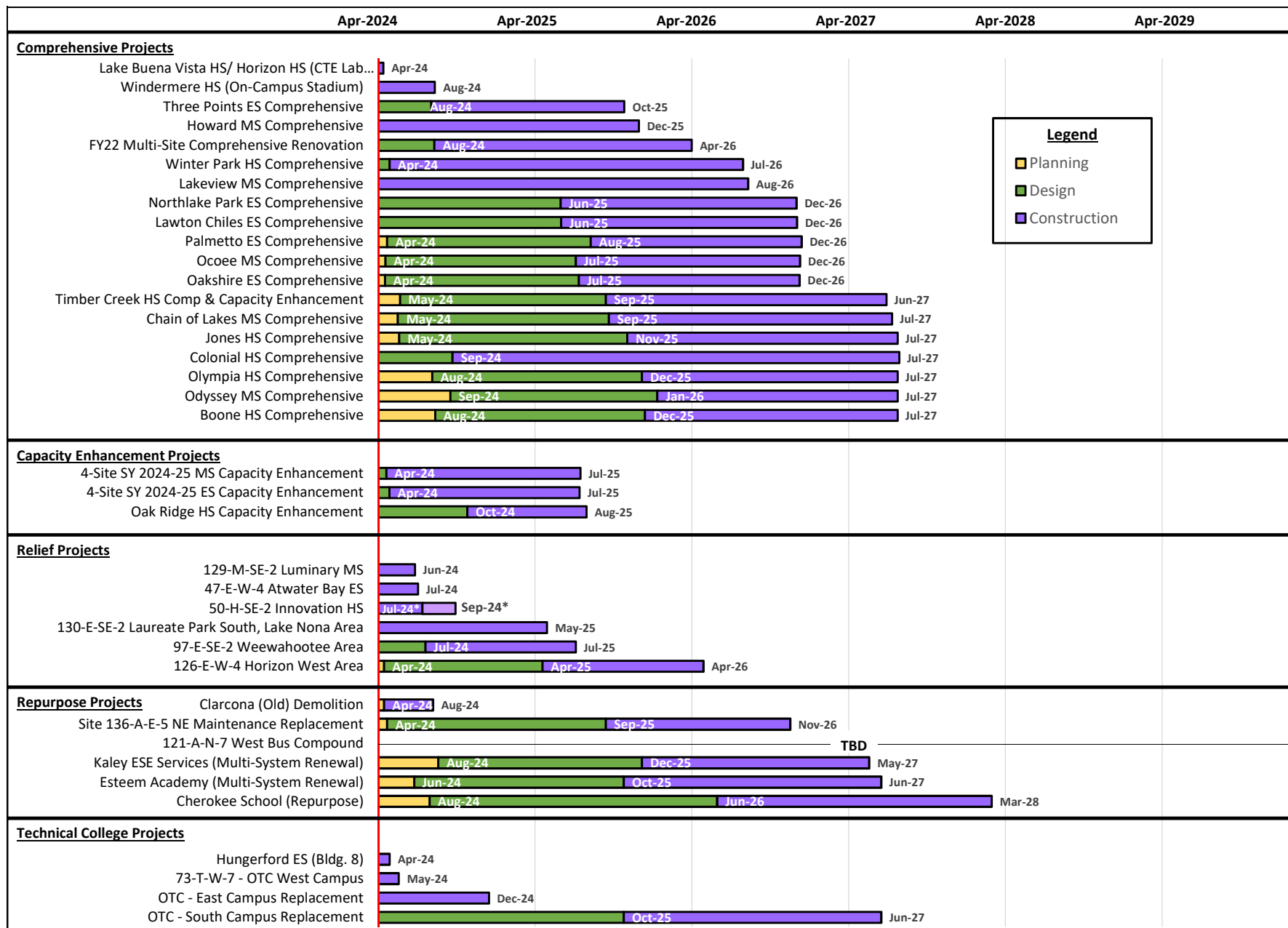

# Capital Program Schedule Summary

---

## Variance Report

Project	Substantial Completion	Explanations
Orlando Technical College Comprehensive		Substantial completion achieved and project moved to close-out
Hungerford ES (Bldg. 8)	(6.9) Wks	Substantial completion delayed due to extended delivery of select electrical equipment.

**PROJECT BUDGET UPDATE**



**PROJECT STATUS SUMMARY REPORT**  
**NEW AND REPLACEMENT SCHOOLS**  
 April 16, 2024

Funding Source(s)	Priority #	School Name	F1	F2	F3	Estimated Cost At Completion	Variance	GMP Amount	F4		F5		Approved Construction		F6 Number of Days Past Substantial (Close-out)	Contract Type	CM / GC Firm	AE Firm			
			FY 2024 Board Adopted Budget	Changes from FY 2024 Adopted Budget	Current Board Adopted Budget				Construction Change Orders	ODP Change Orders	NTP Construct	Substantial Compl	Amount	#					Deducts	#	
			<b>Budget</b>																		
<b>PLANNING PHASE</b>																<b>Schedule</b>			<b>Contracting</b>		
Impact	New	Site 126-E-W-4	45,535,000	-	45,535,000	45,535,000	-														
CIT	New	Site 136-A-E-5 (NE Maint Repl)	20,000,000	-	20,000,000	20,000,000	-														
<b>Sub Total</b>			<b>65,535,000</b>	<b>-</b>	<b>65,535,000</b>	<b>65,535,000</b>	<b>-</b>														
<b>DESIGN PHASE</b>																					
ST, Impact	New	Site 97-E-SE-2	45,622,000	-	45,622,000	45,622,000	-										Welbro	Schenkel			
CIT	New	Site 121-A-W-7 (West Bus Compound)	43,205,000	-	43,205,000	43,205,000	-										Pirtle	Spiezle			
<b>Sub Total</b>			<b>88,827,000</b>	<b>-</b>	<b>88,827,000</b>	<b>88,827,000</b>	<b>-</b>														
<b>CONSTRUCTION PHASE</b>																					
Impact	New	Atwater Bay ES (Site 47-E-W-4)	44,995,000	-	44,995,000	44,995,000	-	36,973,822	276,856	1	(9,822,963)	2	7/12/2023	7/5/2024		GMP	Welbro	Schenkel			
Sales Tax	New	Hungerford ES (renov Bldg 8)	6,720,000	-	6,720,000	6,720,000	-	3,836,726	-		(631,727)	1	11/11/2022	4/30/2024		GMP	Johnson Laux	Schenkel			
ST, Impact, CIT	New	Innovation HS (Site 50-H-SE-2)	230,000,000	-	230,000,000	230,000,000	-	198,036,960	341,167	13	(40,065,836)	6	8/29/2022	9/30/2024		GMP	CORE	Zyscovich			
CIT, Impact	New	Luminary MS (Site 129-M-SE-2)	79,433,000	-	79,433,000	79,433,000	-	68,597,308	346,558	4	(17,690,998)	2	2/23/2023	6/28/2024		GMP	Walker	Schenkel			
Sales Tax	134	Site 73-T-W-7 (OTC West Campus)	64,805,000	-	64,805,000	64,805,000	-	48,931,894	759,141	2	(12,235,000)	2	8/26/2022	5/21/2024		GMP	Wharton	DLR Group			
Impact	New	Site 130-E-SE-2	45,622,000	-	45,622,000	45,622,000	-	35,154,654	-		(8,788,664)	1	12/20/2023	05/01/2025		GMP	Wharton	Schenkel			
Sales Tax	135	Site 512-T-E-1 (OTC East Campus)	63,994,000	-	63,994,000	63,994,000	-	50,325,542	-		(10,973,569)	1	6/1/2023	12/17/2024		GMP	CPPI	DLR Group			
<b>Sub Total</b>			<b>535,569,000</b>	<b>-</b>	<b>535,569,000</b>	<b>535,569,000</b>	<b>-</b>	<b>441,856,907</b>	<b>1,723,722</b>	<b>20</b>	<b>(100,208,758)</b>	<b>15</b>									
<b>CLOSE OUT PHASE</b>																<b>Actual</b>					
Impact	New	Water Spring MS (Site 65-M-W-4)	50,480,000	-	50,480,000	50,480,000	-	42,828,832	(43,565)	1	(15,398,679)	4	11/15/2021	8/1/2023	259	GMP	CORE	Harvard Jolly			
<b>Sub Total</b>			<b>50,480,000</b>	<b>-</b>	<b>50,480,000</b>	<b>50,480,000</b>	<b>-</b>	<b>42,828,832</b>	<b>(43,565)</b>	<b>1</b>	<b>(15,398,679)</b>	<b>4</b>									
<b>Grand Total</b>			<b>740,411,000</b>	<b>-</b>	<b>740,411,000</b>	<b>740,411,000</b>	<b>-</b>	<b>484,685,739</b>	<b>1,680,157</b>	<b>21</b>	<b>(115,607,437)</b>	<b>19</b>									

**Footnotes**

- F1 - Reflects the amount from the 10 yr Capital Budget dated September 13, 2023.
- F2 - Reflects changes to the FY 2024 adopted budget.
- F3 - Amount comprised of prior year expenditures, current and future planned funding (Adopted Summary Budget FY 2024). There are no land costs included.
- F4 - Reflects number of change orders and cumulative change order amount. Does not include ODP deductive and reconciliation change orders.
- F5 - Reflects the amount and number of ODP deductive and reconciliation change orders to date.
- F6 - Reflects number of days beyond substantial completion. See justification below under Close Out Delays.

**Other**

**Completion Delays**

Hungerford ES (renov Bldg 8) - Substantial completion delayed due to extended delivery of select electrical equipment.

**Projects Closed Since Last Report**

None

**Final Budget Variance**

**Final ODP %**

**Close Out Delays**

Water Spring MS (Site 65-M-W-4) - Completion of closeout deliverables and reconciliation of final project costs. Projected date of closeout is May 2024.



PROJECT STATUS SUMMARY REPORT

COMPREHENSIVE SCHOOLS

April 16, 2024

Funding Source	Priority #	School Name	F1 FY 2024 Board Adopted Budget	F2 Changes from FY 2024 Adopted Budget	F3 Current Board Adopted Budget	Estimated Cost At Completion	Variance	GMP Amount	F4 Construction Change Orders		F5 ODP Change Orders		Approved Construction		F6 Number of Days Past Substantial (Close-out)	Contract Type	CM / GC Firm	AE Firm
									Amount	#	Deducts	#	NTP Construct	Contract Subst. Com				
<b>Budget</b>													<b>Schedule</b>		<b>Contracting</b>			
<b>PLANNING PHASE</b>																		
Sales Tax		Boone HS	79,589,000	-	79,589,000	79,589,000	-											
Sales Tax		Chain of Lakes MS	52,200,000	-	52,200,000	52,200,000	-											
CIT		Clarcona (Old) Demolition	1,277,000	-	1,277,000	1,277,000	-											
CIT		Cherokee School (Repurpose)	67,000,000	-	67,000,000	67,000,000	-											
CIT		Esteem Academy (Repurpose)	50,122,000	-	50,122,000	50,122,000	-											
Sales Tax		Jones HS	61,026,000	-	61,026,000	61,026,000	-											
CIT		Kaley ESE Services (Repurpose)	20,198,000	-	20,198,000	20,198,000	-											
Sales Tax		Oakshire ES	27,500,000	-	27,500,000	27,500,000	-											
Sales Tax		Ocoee MS	60,564,000	-	60,564,000	60,564,000	-											
Sales Tax		Odyssey MS	47,733,000	-	47,733,000	47,733,000	-											
Sales Tax		Olympia HS	98,682,000	-	98,682,000	98,682,000	-											
Sales Tax		Palmetto ES	40,500,000	-	40,500,000	40,500,000	-											
Sales Tax, CIT		Timber Creek HS (Comprehensive & Capacity Enhancement)	129,335,000	-	129,335,000	129,335,000	-											
		<b>Sub Total</b>	<b>735,726,000</b>	<b>-</b>	<b>735,726,000</b>	<b>735,726,000</b>	<b>-</b>											
<b>DESIGN PHASE</b>																		
Sales Tax		Colonial HS	97,655,000	-	97,655,000	97,655,000	-										Wharton	Schenkel
Sales Tax		FY22 Multi-Site Comprehensive Reno	96,624,000	-	96,624,000	96,624,000	-										Wharton	Zyscovich
Sales Tax		Lawton Chiles ES	32,100,000	-	32,100,000	32,100,000	-											Lego
Sales Tax		Northlake Park ES	44,550,000	-	44,550,000	44,550,000	-											Welbro
Sales Tax		Oak Ridge HS Functional Equity	20,750,000	-	20,750,000	20,750,000	-											Welbro
Sales Tax	133	OTC South Campus	197,000,000	-	197,000,000	197,000,000	-										Williams	Harvard Jolly
Sales Tax		SY 2024-25 ES Functional Equity	34,109,000	-	34,109,000	34,109,000	-											McCree
Sales Tax		SY 2024-25 MS Functional Equity	46,567,000	-	46,567,000	46,567,000	-											Thorton
Sales Tax		Three Points ES	22,825,000	-	22,825,000	22,825,000	-											Core
Sales Tax		Winter Park HS	90,903,000	-	90,903,000	90,903,000	-											CPPI
		<b>Sub Total</b>	<b>683,083,000</b>	<b>-</b>	<b>683,083,000</b>	<b>683,083,000</b>	<b>-</b>											
<b>CONSTRUCTION PHASE</b>																		
Sales Tax		Howard MS	60,831,000	-	60,831,000	60,831,000	-	45,106,554			(10,662,670)	1	6/12/2023	12/1/2025		GMP	Lego	Rhodes + Brito
LBV-Impact, CIT; Horizon-Impact, Sales Tax		Lake Buena Vista HS/ Horizon HS (CTE Lab Conversions & Misc.)	3,476,000	-	3,476,000	3,476,000	-	1,236,791	53,000	1	(131,608)	1	3/16/2023	4/15/2024		GMP	Wharton	Schenkel
Sales Tax		Lakeview MS	48,891,000	-	48,891,000	48,891,000	-	36,395,080	-	-	-	-	11/29/2023	8/12/2026		GMP	Wharton	Song + Assoc.
Sales Tax		Windermere HS (On-Campus Stadium)	6,800,000	-	6,800,000	6,800,000	-	4,615,828	-	-	-	-	2/7/2024	8/13/2024		GMP	Wharton	Schenkel
		<b>Sub Total</b>	<b>119,998,000</b>	<b>-</b>	<b>119,998,000</b>	<b>119,998,000</b>	<b>-</b>	<b>87,354,253</b>	<b>53,000</b>	<b>1</b>	<b>(10,794,278)</b>	<b>2</b>						
<b>CLOSE OUT PHASE</b>																		
Sales Tax	136	Orange Technical College	47,020,000	-	47,020,000	47,020,000	-	35,352,358	375,135	3	(5,932,626)	1	3/24/2022	3/27/2024	20	GMP	Gilbane	Harvard Jolly
		<b>Sub Total</b>	<b>47,020,000</b>	<b>-</b>	<b>47,020,000</b>	<b>47,020,000</b>	<b>-</b>	<b>35,352,358</b>	<b>375,135</b>	<b>3</b>	<b>(5,932,626)</b>	<b>1</b>						
<b>Grand Total</b>			<b>1,585,827,000</b>	<b>-</b>	<b>1,585,827,000</b>	<b>1,585,827,000</b>	<b>-</b>	<b>122,706,611</b>	<b>428,135</b>	<b>4</b>	<b>(16,726,904)</b>	<b>3</b>						

Footnotes

- F1 - Reflects the amount from the 10 yr Capital Budget dated September 13, 2023.
- F2 - Reflects changes to the FY 2024 adopted budget.
- F3 - Amount comprised of prior year expenditures, current and future planned funding (Adopted Summary Budget FY 2024). There are no land costs included.
- F4 - Reflects number of change orders and cumulative change order amount. Does not include ODP deductive and reconciliation change orders.
- F5 - Reflects the amount and number of ODP deductive and reconciliation change orders to date.
- F6 - Reflects number of days beyond substantial completion. See justification below under Close Out Delays.

Multiple Sites Projects

1. SY 2024-25 MS Functional Equity includes improvements at 3 sites: College Park MS, Hunters Creek MS, and Westridge MS
2. SY 2024-25 ES Functional Equity includes improvements at 3 sites: Dr. Phillips ES, Hunters Creek ES, and Whispering Oak ES.
3. FY22 Multi-Site Comprehensive Renovation includes improvements at 4 sites: Avalon ES, Camelot ES, Citrus ES, and Endeavor ES.

Completion Delays

None

Close Out Delays

None

Projects Closed Since Last Report

None

Final Budget Variance

Final ODP %



Project Status Summary Report

Capital Renewal Projects (Note 1)

April 18, 2024

Project Size Key  
 Lg - Constr. Amount > \$2M  
 Int - Constr. Amount > \$280K and < \$2M  
 Sm - Constr. Amount < \$280K

Location	Wt'd Age (FISH)	Project Number	Size	Project Elements											Prior Project Budget	Project Budget Changes	Current Project Budget	Current Estimated Cost At Completion	Variance from Current Project Budget	GMP Amount	Construction Change Orders		ODP Change Orders		Approved Construction		Number of Days Past Subst. Compl. (close-out)	Contract Type	CM / GC Firm	AE Firm					
				Site	Roofing	Structural	Exterior	Interior	Mechanical	Electrical	Plumbing	Life Safety	Technology	Conveyance							Specialties	Amount	#	Deducts	#	NTP Construct					Subst. Compl.				
<b>PLANNING PHASE</b>																							<b>Budget</b>				<b>Schedule</b>		<b>Contracting</b>						
Audubon Park School	7-Yr	N0211.0	Int														604,000	-	604,000	604,000	-														
Discovery MS	28-Yr	N0192.0	Lg		✓												4,719,000	-	4,719,000	4,719,000	-														
Dr Phillips HS	12-Yr	N0188.0	Int	✓			✓										2,223,000	-	2,223,000	2,223,000	-														
Hillcrest ES	7-Yr	N0199.0	Int		✓												390,000	-	390,000	390,000	-														
Hunters Creek MS	31-Yr	N0215.0	Lg		✓												-	3,961,000	3,961,000	3,961,000	-														
FY24 Multi-Site Auditorium Refresh	-	N0212.0	Lg					✓		✓			✓		✓		-	14,490,000	14,490,000	14,490,000	-														
FY24 Multi-Site Exterior Painting	-	N0216.0	Lg				✓										-	3,901,000	3,901,000	3,901,000	-														
FY24 Multi-Site CCTV Replacement (Exer)	-	N0204.0	Lg								✓		✓				6,281,000	-	6,281,000	6,281,000	-														
FY24 Multi-Site Chiller R'newal	-	N0206.0	Int						✓	✓	✓						1,726,000	-	1,726,000	1,726,000	-														
FY24 Multi-Site Intrusion Detection (Grp 1)	-	N0196.0	Int							✓							1,008,000	-	1,008,000	1,008,000	-														
FY24 Multi-Site Cooling Tower Refurb	-	N0210.0	Lg	✓					✓								3,315,000	-	3,315,000	3,315,000	-														
FY24 Multi-Site Intrusion Detection Grp 2	-	N0203.0	Lg							✓							2,256,000	-	2,256,000	2,256,000	-														
FY24 Multi-Site Low Voltage BAS Controls	-	N0207.0	Lg							✓		✓	✓				4,157,000	-	4,157,000	4,157,000	-														
Oak Ridge HS	13-Yr	N0197.0	Int							✓		✓	✓				1,109,000	-	1,109,000	1,109,000	-														
Orlo Vista ES	20-Yr	N0205.0	Sm				✓										106,000	-	106,000	106,000	-														
Metrowest ES	12-Yr	N0182.0	Int						✓								567,658	-	567,658	567,658	-														
Rosemont ES	24-Yr	N0090.2	Int	✓			✓										352,352	-	352,352	352,352	-														
West Orange HS	16-Yr	N0194.0	Int	✓													1,100,000	-	1,100,000	1,100,000	-														
Washington Shores PLC	18-Yr	N0213.0	Int	✓			✓										-	394,000	394,000	394,000	-														
<b>SUBTOTAL (Planning)</b>		<b>19 Projects</b>	<b>81 Sites</b>												<b>29,914,010</b>	<b>22,746,000</b>	<b>52,660,010</b>	<b>52,660,010</b>	<b>-</b>																
<b>DESIGN / PRE-CONSTRUCTION PHASE</b>																																			
Apopka HS	16-Yr	N0136.0	Lg	✓	✓		✓		✓	✓		✓					19,292,000	-	19,292,000	19,292,000	-											Bishop Construction	RGD		
FY22 LED Conversion Pilot at 03-Sites	-	N0159.0	Int							✓							4,415,000	-	4,415,000	4,415,000	-										Schmid Construction	Voltair			
FY22 Exterior Painting Group 1	-	N0123.0	Int				✓										2,325,000	-	2,325,000	2,325,000	-										TBD	Gale			
FY22 Exterior Painting Group 2	-	N0162.0	Lg				✓										3,357,000	-	3,357,000	3,357,000	-										TBD	Gale			
FY23 Multi-Site Exterior Painting	-	N0176.0	Int				✓										2,088,000	-	2,088,000	2,088,000	-										TBD	Gale			
HVAC at 02-Sites	-	N0125.0	Lg	✓	✓				✓	✓		✓					16,461,000	-	16,461,000	16,461,000	-										Lego Construction	GRäEF-USA			
HVAC at 02-Sites	-	N0139.0	Lg						✓	✓							22,289,000	-	22,289,000	22,289,000	-										Johnson-Laux	TLC Engineering			
HVAC at 02-Sites	-	N0140.0	Lg						✓	✓		✓					22,872,000	-	22,872,000	22,872,000	-										McCree	OCI Engineering			
HVAC at 05-Sites	-	N0105.0	Lg						✓	✓	✓						21,357,000	-	21,357,000	21,357,000	-										Lego Construction	Matern			
Lockhart MS	16-Yr	N0138.0	Lg	✓													6,890,000	-	6,890,000	6,890,000	-										Votum	Baker Barrios			
Dommerich ES/ Maitland MS	-	N0137.0	Lg	✓		✓		✓	✓	✓		✓	✓		✓		12,555,000	-	12,555,000	12,555,000	-										Welbro	SGM			
Lakemont ES/ Windy Ridge K8	-	N0144.0	Lg	✓		✓	✓	✓	✓	✓	✓	✓	✓	✓	✓		18,799,000	-	18,799,000	18,799,000	-										Votum	SGM			
Multi-System Group 1	-	N0142.0	Lg	✓	✓		✓	✓	✓	✓	✓	✓	✓	✓	✓	✓	32,262,000	-	32,262,000	32,262,000	-										Wharton Smith	Matern			
Ocoee HS	19-Yr	N0099.0	Lg						✓	✓	✓	✓	✓				27,416,000	-	27,416,000	27,416,000	-										T&G Constructors	GRäEF-USA			
Piedmont Lakes MS	31-Yr	N0119.0	Lg					✓	✓	✓	✓						17,690,000	-	17,690,000	17,690,000	-										CPPI	Bobes Associate			
Rosemont ES	24-Yr	N0090.0	Lg	✓	✓		✓		✓	✓		✓	✓		✓		5,871,000	-	5,871,000	5,871,000	-										SkyBuilders USA	TLC			
Tildenville ES	20-Yr	N0131.0	Lg	✓					✓	✓	✓	✓	✓				9,452,000	-	9,452,000	9,452,000	-										Johnson-Laux	OCI			
Union Park MS	18-Yr	N0132.0	Lg	✓	✓	✓			✓	✓							5,311,000	-	5,311,000	5,311,000	-										Messam	Little Diversified			
Union Park MS	18-Yr	N0191.0	Lg	✓	✓		✓										4,759,000	-	4,759,000	4,759,000	-										TBD	ARC			
Westbrooke ES	16-Yr	N0155.0	Lg						✓	✓							6,598,000	-	6,598,000	6,598,000	-										Williams	GRäEF-USA			
<b>SUBTOTAL (Design/Pre-Con)</b>		<b>20 Projects</b>	<b>57 Sites</b>												<b>262,059,000</b>	<b>-</b>	<b>262,059,000</b>	<b>262,059,000</b>	<b>-</b>																







**Project Status Summary Report**

**Capital Renewal Projects** (Note 1)

April 18, 2024

**Project Size Key**  
 Lg - Constr. Amount > \$2M  
 Int - Constr. Amount > \$280K and < \$2M  
 Sm - Constr. Amount < \$280K

**Project Elements**

Location	Wt'd Age (FISH)	Project Number	Size	Site	Roofing	Structural	Exterior	Interior	Mechanical	Electrical	Plumbing	Life Safety	Technology	Conveyance	Specialties	Prior Project Budget	Project Budget Changes	Current Project Budget	Current Estimated Cost At Completion	Variance from Current Project Budget	GMP Amount	Construction Change Orders		ODP Change Orders		Approved Construction		Number of Days Past Subst. Compl. (close-out)	Contract Type	CM / GC Firm	AE Firm
																						Amount	#	Deducts	#	NTP Construct	Subst. Compl.				

Location				Project Number		Size		Explanation of Project Budget Changes
<b>PLANNING PHASE</b>								
Hunters Creek MS	31-Yr	N0215.0	Lg	Added project				
FY24 Multi-Site Auditorium Refresh	-	N0212.0	Lg	Added project				
FY24 Multi-Site Exterior Painting	-	N0216.0	Lg	Added project				
Washington Shores PLC	18-Yr	N0213.0	Int	Added project				
<b>CONSTRUCTION PHASE</b>								
Avalon MS	18-Yr	N0200.0	Sm	Budget updated to reflect firm vendor pricing				
Southwest MS	26-Yr	N0209.0	Sm	Added project				
Windy Ridge K8	18-Yr	N0178.0	Int	Budget updated to reflect firm vendor pricing				

- Budget**
- Multiple Sites Projects, with Florida Inventory of School Houses (FISH) Wt'd Age in [brackets]:**
- N0101.0 consists of chiller replacement at 2 campuses: Roberto Clemente MS [20] and Lake Sybelia ES [14].
  - N0102.0 consists of select roof replacement at 3 campuses: Sadler ES [38], Windermere ES [17], and Windy Ridge K8 [17].
  - N0103.0 consists of select roof replacement at 2 campuses: Avalon MS [17] and Meadowbrook MS [18].
  - N0105.0 consists of select HVAC replacement at 5 campuses: Castle Creek ES [17], Columbia ES [16], West Oaks ES [19], Windermere ES [17], and Wolf Lake ES [17].
  - N0120.0 consists of intrusion detection, fire alarm, intercom, and/ or security camera replacement at 38 campuses: Apopka ES [10]; Baldwin Park ES [16]; Blankner K8 [22]; Bridgewater MS [16]; Dillard St ES [19]; Eagle's Nest ES [20]; East Lake ES [18]; East River HS [14]; Evans HS [13]; Freedom HS [20]; Freedom MS [18]; Killarney ES [14]; Lake Nona HS [14]; Lakeville ES [24]; Legacy MS [18]; Liberty MS [18]; Maitland MS [14]; McCoy ES [18]; Meadowbrook MS [18]; Memorial MS [15]; Ocoee HS [18]; OTC-Avalon Campus [15]; Ridgewood Park ES [17]; Riverdale ES [25]; Sadler ES [38]; Sand Lake ES [18]; South Creek MS [17]; Timber Lakes ES [15]; Union Park MS [17]; Waterbridge ES [13]; Waterford ES [15]; West Oaks ES [19]; West Orange HS [15]; Windermere ES [17]; Windy Ridge K8 [17]; Wolf Lake ES [17]; Wolf Lake MS [17]; Wyndham Lakes ES [17].
  - N0123.0 consists of exterior painting at 17 campuses: Aloma ES [11]; Azalea Park ES [12]; Cypress Springs ES [12]; Forsyth Woods ES [13]; Lake Sybelia ES [14]; Lancaster ES [12]; Metrowest ES [11]; Princeton ES [12]; Rock Springs ES [12]; Sadler ES [38]; Sand Lake ES [18]; Shenandoah ES [16]; Southwood ES [26]; Sunridge ES [11]; Wetherbee ES [12]; Wyndham Lakes ES [17]; Zellwood ES [12].
  - N0125.0 consists of select HVAC replacement at 2 campuses: Dillard Street ES [19] and Hiawassee ES [20].
  - N0137.0 consists of multi-system improvements at 2 campuses: Dommerich ES [14] and Maitland MS [14].
  - N0139.0 consists of select HVAC replacement at 2 campuses: Wekiva HS [16] and West Orange HS [15].
  - N0140.0 consists of select HVAC replacement at 2 campuses: East River HS [14] and Lake Nona HS [14].
  - N0142.0 consists of multi-system improvements at 5 campuses: Columbia ES [16]; Moss Park ES [16]; Stone Lakes ES [17]; Vista Lakes ES [17]; West Creek ES [19].
  - N0144.0 consists of multi-system improvements at 2 campuses: Lakemont ES [15]; Windy Ridge K8 [17].
  - N0147.0 consists of select HVAC replacement at 7 campuses: Baldwin Park ES [16]; Eagle's Nest ES [20]; McCoy ES [18]; Millennia ES [17]; Whispering Oak ES [18]; Wyndham Lakes ES [17].
  - N0151.0 consists of chiller replacement at 4 campuses: Killarney ES [14]; Robinswood MS [15]; Timber Lakes ES [15]; Walker MS [13].
  - N0158.0 consists of CCTV security cameras replacement at 18 campuses: Arbor Ridge K8 [11]; Avalon MS [17]; Castle Creek ES [17]; Catalina ES [16]; Colonial 9GC [22]; Eccleston ES [10]; Forsyth Woods ES [13]; Keene's Crossing [14]; Lake Nona MS [12]; Lancaster ES [12]; Lockhart MS [15]; Palm Lake ES [14]; Pinewood ES [26]; Princeton ES [12]; Shenandoah ES [16]; Sunridge ES [11]; Walker MS [13]; Washington Shores PLC [17].
  - N0159.0 consists of LED retrofit at 3 campuses: Freedom MS [18]; Freedom HS [20]; West Creek ES [19].
  - N0162.0 consists of exterior painting at 9 campuses: Acceleration East [21]; Apopka 9GC [28]; Apopka HS [15]; Edgewater HS [13]; Evans HS [13]; Hunter's Creek MS [30]; South Creek MS [17]; Sunridge MS [11]; Westridge MS [12].
  - N0168.0 consists of select HVAC replacement at 3 campuses: Bonneville ES [22]; Legacy MS [18]; Washington Shores PLC [17].
  - N0169.0 consists of chiller r'newal at 5 campuses: Freedom MS [18]; Meadowbrook MS [18]; Olympia HS [23]; Timber Creek HS [24]; Winter Park 9GC [13].
  - N0172.0 consists of CCTV security cameras replacement at 14 campuses: Aloma ES [11]; Azalea Park ES [12]; Bonneville ES [22]; Brookshire ES [10]; Cypress Springs ES [12]; Edgewater HS [13]; Hunter's Creek ES [13]; Lake Sybelia ES [14]; Prairie Lake ES [10]; Rock Springs ES [12]; Sun Blaze ES [10]; Sunridge MS [11]; Wetherbee ES [12]; Zellwood ES [12].
  - N0176.0 consists of exterior painting at 7 campuses: Arbor Ridge K8 [11]; Brookshire ES [10]; Colonial 9GC [22]; Freedom HS [20]; Freedom MS [18]; Lakeville ES [24]; Sun Blaze ES [10].
  - N0189.0 consists of chiller coil replacement at 3 campuses: Cypress Creek HS [9]; Dr. Phillips HS [11]; Hunter's Creek MS [30].
  - N0190.0 consists of carpet replacement at 14 campuses: Blankner K8 [22]; Dillard St ES [19]; Hiawassee ES [19]; Jones HS [19]; Lakeville ES [24]; McCoy ES [18]; Metrowest ES [11]; Olympia HS [23]; Orange Center ES [14]; Roberto Clemente MS [20]; Robinswood MS [15]; Stone Lakes ES [17]; Thornbrooke ES [20]; West Oaks ES [18].
  - N0196.0 consists of intrusion detection improvements at 8 campuses: Bonneville ES [23]; Colonial 9GC [23]; Corner Lake MS [27]; Discovery MS [28]; Dr Phillips HS [12]; Orlo Vista ES [20]; Southwood ES [27]; Washington Shores PLC [18].
  - N0200.0 consists of auditorium refresh at 4 campuses: Edgewater HS [14]; Freedom HS [21]; Ocoee HS [19]; West Orange HS [16].
  - N0201.0 consists of intercom replacement at 3 campuses: Gotha MS [29]; Lancaster ES [12]; Lockhart MS [15].
  - N0202.0 consists of youth and tot lot replacement at 12 campuses: Andover ES [19]; Blankner K8 [23]; Dillard St ES [20]; Eagle's Nest ES [20]; East Lake ES [19]; Hiawassee ES [20]; McCoy ES [19]; Orlo Vista ES [20]; Sand Lake ES [19]; Thornbrooke ES [21]; West Creek ES [20]; and West Oaks ES [19].
  - N0204.0 consists of CCTV replacement at 19 campuses
  - N0203.0 consists of intrusion detection improvements at 21 campuses: Conway MS [15]; Dommerich ES [15]; East River HS [15]; Forsyth Woods ES [14]; Gotha MS [30]; Hunters Creek ES [14]; Hunters Creek MS [31]; Keene's Crossing ES [15]; Lake Nona HS [15]; Lakemont ES [16]; Maitland MS [15]; Memorial MS [16]; Millennia ES [18]; Ocoee HS [19]; Palm Lake ES [15]; Pinewood ES [27]; Positive Pathways [22]; Sunset Park ES [17]; Memorial MS [16]; Millennia ES [18]; Ocoee HS [19]; Palm Lake ES [15]; Pinewood ES [27]; Positive Pathways [22]; Sunset Park ES [17]; Timber Lakes ES [16]; Waterbridge ES [14]; Westbrooke ES [16].
  - N0206.0 consists of chiller r'newals at 4 campuses: Freedom HS [21]; Glenridge MS [21]; Legacy MS [19]; and South Creek MS [18].
  - N0207.0 consists of BAS improvements at 13 campuses: Aloma ES [12]; Azalea Park ES [13]; Bay Lake ES [9-]; Brookshire ES [11]; Cypress Springs ES [13]; Dream Lake ES [9-]; Lockhart ES [9-]; Mollie Ray ES [8-]; Ocoee ES [10]; Orange Center ES [15]; Palm Lake ES [15]; Pinedale ES [10]; University HS [14].
  - N0210.0 consists of cooling tower refurbishment at 8 campuses: Avalon MS [18]; Bridgewater MS [17]; Freedom HS [21]; Freedom MS [19]; Legacy MS [19]; Meadow Woods MS [20]; South Creek MS [18]; Winter Park 9GC [14].
  - N0216.0 consists of exterior painting at 18 campuses: Corner Lake MS [27]; Dr. Phillips HS [12]; John Young ES [10]; Lake Silver ES [11]; Little River ES [11]; Memorial MS [16]; Ocoee ES [10]; Phillis Wheatley ES [10]; Piedmont Lakes MS [31]; Pinedale ES [10]; Pinewood ES [27]; Riverdale ES [26]; Rock Lake ES [8]; Shingle Creek ES [11]; Spring Lake ES [11]; Sunrise ES [23]; Washington Shores ES [11]; Waterford ES [16].



## OCPS MASTER CLOSEOUT REPORT

CAPITAL PROJECT

----- CAPITAL RENEWAL PROJECTS -----

	Water Spring MS	Thornebrooke ES	Liberty MS Serving Line	Roofing at 04-Sites	Liberty MS Plumbing
<b>Project Number</b>	S-0097	N-0091.0	N-0167.0	N-0102.0	N-141.0
<b>Project Manager</b>	Tamara Cox	Bonni Johnson	Kenneth Marcum	Kenneth Marcum	Kenneth
<b>Architect of Record</b>	Harvard Jolly	GRaEF-USA	Baker Barrios	Gale Associates	Baker Barrios
<b>Construction Manager</b>	CORE	CPPI	SkyBuilders USA	Lego Construction	SkyBuilders USA
<b>Substantial Completion</b>	08/01/23	08/09/23	08/30/23	09/29/23	10/26/23
<b>Closeout Complete (Exhibit H)</b>	May '24	May '24	June '24	May '24	June '24

CLOSEOUT DELIVERABLE					
O & M Manuals	Completed	Completed	Missing (1)	Completed	Completed
Environmental Closeout Manual	Completed	Completed	CM to revise	Completed	CM to revise
Warranty Certificates	Completed	Completed	Missing (9)	Missing (1)	Missing (4)
Master Consolidated Punch List (signed-off)	Completed	Completed	WIP	Completed	WIP
Return of Items Procured w/GRs (\$75+)	Completed	Completed	Completed	Completed	Completed
As-Built Drawings	Completed	Completed	Completed	Completed	Missing (1) from subcontractor
As-Built Project Manuals	Completed	Completed	WIP	Completed	Completed
Record Drawings & Project Manuals	Completed	Completed	WIP	Completed	WIP
Certificate of Substantial Completion	Completed	Completed	Completed	Completed	Completed
Certificate of Occupancy	Completed	Completed	Completed	Completed	Completed
Attic Stock	Completed	Completed	Missing (1)	N/A	Missing (1)
Training	Completed	Completed	Missing (3)	N/A	Completed
Specific Easements	Completed	N/A	N/A	N/A	WIP
Sustainability Letter & Score Card	Completed	N/A	N/A	N/A	N/A
OEF 564 - Cost Breakdown Info	Completed	N/A	N/A	N/A	N/A
Final CRs & COs (excluding ODP / GMP reconciliation)	Missing (1) CR & (1) Time CO	Missing (3) CRs & (1) Time CO	Missing (2) CRs & (1) Time CO	Completed	Missing (3) CRs & (1) Time CO
Final ODP Reconciliation Change Order	Completed	Pending OCPS Fiscal Report	Missing (1) closeout letter	Completed	Pending OCPS Fiscal Report
Final GMP Reconciliation Change Order	Pending other CRs and COs	Pending other CRs and COs	Pending other CRs and COs	WIP	Pending other CRs and COs
Certificate of Final Inspection (CFI)	Pending Final GMP CO	Pending Final GMP CO	Pending Final GMP CO	Pending Final GMP CO	Pending Final GMP CO
Final Pay Application	Pending Final GMP CO	Pending Final GMP CO	Pending Final GMP CO	Pending Final GMP CO	Pending Final GMP CO

# Capital Renewal Forecast

Reporting Period: March 2024 - February 2026

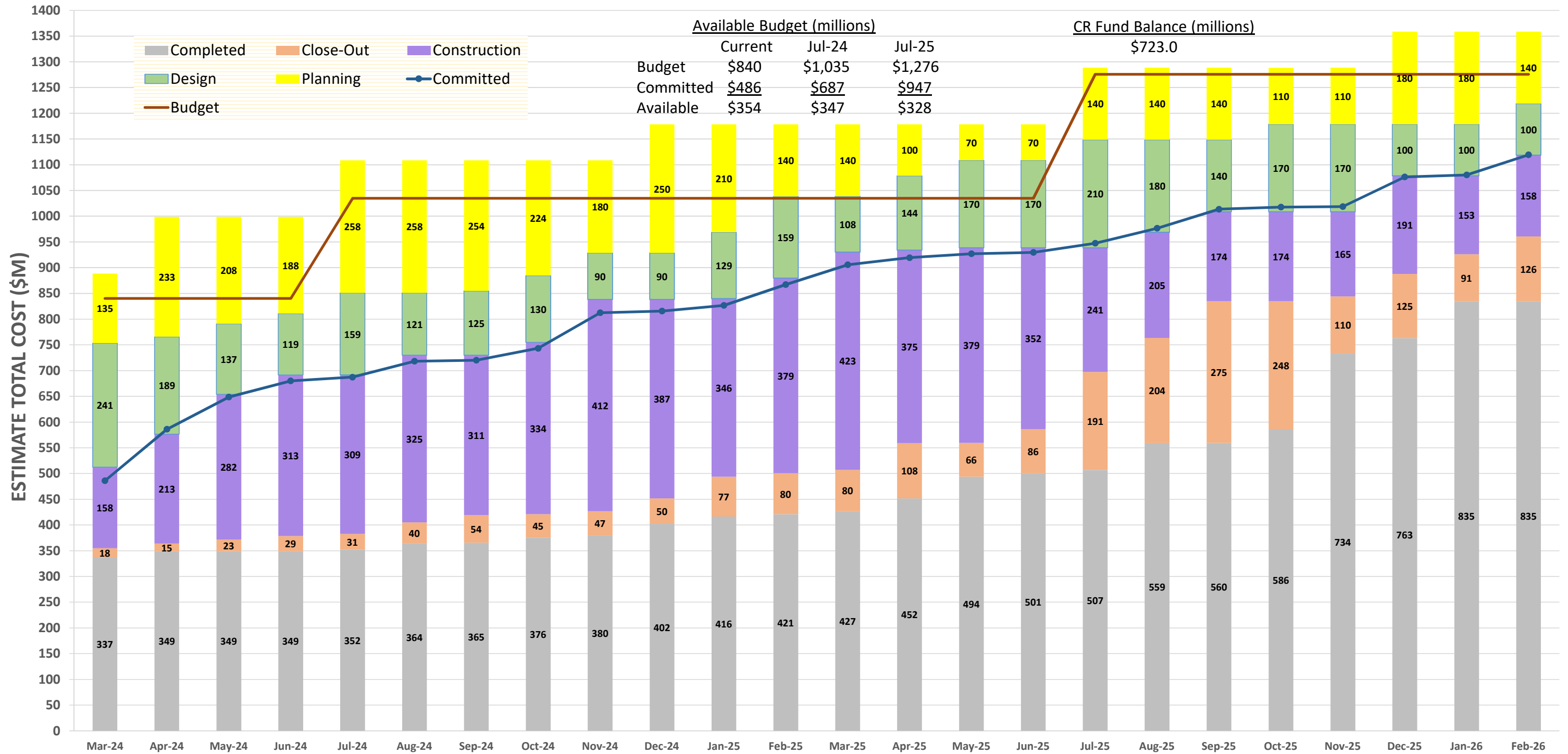

## **PROJECT STATUS REPORT**

## Capital Construction Update as of April 18, 2024

We continue with eleven (11) projects under construction.

### Four (4) Comprehensive Projects:

- **Orange Technical College** (Comprehensive Renovation)

Project has received their TCO and students are moved in.



## Capital Construction Update as of April 18, 2024

- **Hungerford Building 8** (Comprehensive Renovation)

Select renovation of existing Hungerford Building 8 to convert into a welding lab/construction lab using classrooms, restrooms, and spaces for mechanical and electrical rooms. Existing metal covered play structure to be converted into outdoor welding school and added parking.

**Project Status:** Building 8 is complete and students are moved in. In building 9, we are progressing slowly. Contactors were shipped and will be installed by the end of the month.

The project is anticipated to be completed late April 2024.





## Capital Construction Update as of April 18, 2024

- **Howard MS** (Comprehensive Renovation)

**Project Status:** Project is on schedule. The second floor Phase 1B is underway with Low Voltage rough-in complete. Ongoing work in restrooms continue. Fire alarm and installation of audio enhancement devices is underway. Finishes continue, including painting. The AHU units have arrived and install is in progress. Roofing is also about 80% complete including shingle work over the gym.

**Phase 1:** Anticipated completion early August 2024.

**Phase 2:** Anticipated completion early August 2025.

**Phase 3:** Anticipated completion late November 2025.

**Phase 4:** Anticipated completion early December 2025.

The project is anticipated to be completed early December 2025.





## Capital Construction Update as of April 18, 2024

### ○ Lakeview MS (Comprehensive Renovation)

Notice-to-Proceed was issued on November 29, 2023. Comprehensive renovation and remodeling of the entire campus to provide improved facilities meeting the design guidelines and educational program requirements. The project scope includes all renovations needed to address current deficiencies and upgrade all building and site facilities, systems, and finishes at or near the end of their useful life. The scope also provides for remodeling of existing spaces to support current program, life safety and accessibility requirements and also includes any temporary facilities and classrooms required to support construction phasing.

**Phase 1:** Anticipated completion early September 2024.

**Phase 2:** Anticipated completion early February 2025.

**Phase 3:** Anticipated completion late September 2025.

**Phase 4:** Anticipated completion early August 2025.

**Phase 5:** Anticipated completion early July 2026.

**Phase 6:** Anticipated completion early August 2026.

**Project Status:** Building Permit was received; procurement of materials is underway. Portable install for swing space anticipated to begin late April 2024.

The project is anticipated to be completed late August 2026.



## Capital Construction Update as of April 18, 2024

### Four (4) New Relief Projects:

- **Luminary Middle School** (Site 129-M-SE-2) (Greenfield school)

**Project Status:** The project is moving along on schedule. Site work continues with fencing and sod. Bus loop is graded and curb is underway. Courtyard benches and grading for flat work has started. OUC transformer is energized and the building is under permanent power. Rough-out of mechanical trades is completed in all buildings. Finishes chase the drywall crews with spackling and painting. Painting is completed in the classroom building and ceiling grid is underway.

The project is anticipated to be completed late June 2024.



**WALKER**  
& COMPANY

Site 129-M-SE-2 M.S. Relief  
3-20-24



aerial  
Innovations



## Capital Construction Update as of April 18, 2024

- **Atwater Bay ES** (Site 47-E-W-4) (Greenfield school)

**Project Status:** Project is moving along on schedule. Sanitary sewer lines are complete, water tap is completed and the transformer is energized with permanent power to the building. Sidewalks and curbing are well underway. All framing and drywall is completed. Finishes are underway in various stages throughout the building. Ceiling grid is completed in the classroom area and MEP trim out is underway with install of light fixtures and grills. Drywall finishing continues in the cafeteria and kitchen. Freezer cooler boxes are installed.

The project is anticipated to be completed in a single phase, in early July 2024.



OCPS Site 47 E-W-4  
Elementary Relief School  
3.20.24



## Capital Construction Update as of April 18, 2024

○ **Innovation HS** (Site 50-H-SE-2) (Greenfield school)

**Phase 1:** Includes construction of Building 100. Anticipated completion early July 2024.

**Phase 2:** Includes construction of Building 200. Anticipated completion mid July 2024.

**Project Status:** The project is moving along on schedule. Offsite roadway work on Founders and Dowden Streets is well underway; curb is poured and traffic signals are installed, waiting for power. Canopy installation is 70 percent complete; preparing to install canopies outside cafetorium. Concrete flat work in courtyard is 50 percent complete. In Building 100; elevator install is underway on both elevators. Quarry tile is completed in the kitchen, polished concrete is completed in the cafeteria, freezers and cooler boxes are installed, ceiling tile is underway on floors one and two, VCT flooring is completed on floors one and two. Ongoing work in building 200; Gym sound panels are installed and floor preparation is underway. Locker install is underway, storefront is completed, scaffolding in auditorium has been removed, preparing for seats to be delivered and exterior painting is nearing completion. Ongoing work in buildings 300, 400 and 500; tile install and painting is in progress and installation of hard ceilings is ongoing.





## Capital Construction Update as of April 18, 2024

- **Site 130-E-SE-2** (Laureate Park) (Greenfield school)

This greenfield elementary school will relieve Laureate Park Elementary and Eagle Creek Elementary schools. A prototype reuse, two-story elementary school on a 30-acre site to incorporate facilities for a middle school (18 acres) and this future elementary school (12 acres) for approximately 836 student stations.

**Project Status:** Procurement of materials is underway. Building permit application was submitted to BCCO and a building permit number was secured. Currently processing change order for Owner Direct Purchase. Expected actual construction start in mid-April 2024.

The project is anticipated to be completed early May 2025.



## Capital Construction Update as of April 18, 2024

### Three (3) Replacement Projects:

- **Site 73-T-W-7 – Orange Technical College / West Campus (Westside)**

**Project Status:** Time extension has been issued. Work continues on site with parking lot paving, curb install and setting of light poles. Interior work has now picked up momentum: transformer is set and energized with permanent power to the buildings to include cooling the building. Ceiling tile install is underway, LVT flooring has begun and moving along quickly, doors and hardware has started in building 100, bathroom fixtures have been installed and low voltage wiring for security and internet is nearly completed.

The project is anticipated to be completed late May 2024.



OTC West Campus Replacement Project  
(Site 73) OCPS Project: S0112  
3.20.24





## Capital Construction Update as of April 18, 2024

- **Site 512-T-E-1 – Orange Technical College / East Campus**

**Project Status:** Project is currently on schedule. Site work continues with parking lot grading and entrance road construction. Roof is water tight with loose ends underway. Interior framing has started on perimeter and critical areas. Spray-on fire stopping underway on second floor, exterior insulation is ongoing. Electrical and Plumbing contractors are also preparing to begin rough-out activities once wall framing is underway.

The project is anticipated to be completed mid-December 2024.



Orange Technical College (OTC)  
East Campus  
3.20.24





## Capital Construction Update as of April 18, 2024

### ○ Windermere High School (On-Campus Football Stadium)

Modification of the existing practice field with track to accommodate on-site home football games, including new home and visitor bleachers to accommodate 1,070 and 480 seating respectively; remove existing practice field lighting and provide new stadium lighting per current prototype standards, and provide new concessions/restroom building, scoreboard, flagpole with lighting, and related site modifications.

**Project Status:** Moving along on schedule. Site work continues with demo of basketball courts. The long jumps have been relocated. Forming for the bleacher relocation has begun. Preparing to start building pad for concession stand with relocation of water lines.

The project is anticipated to be completed early August 2024.

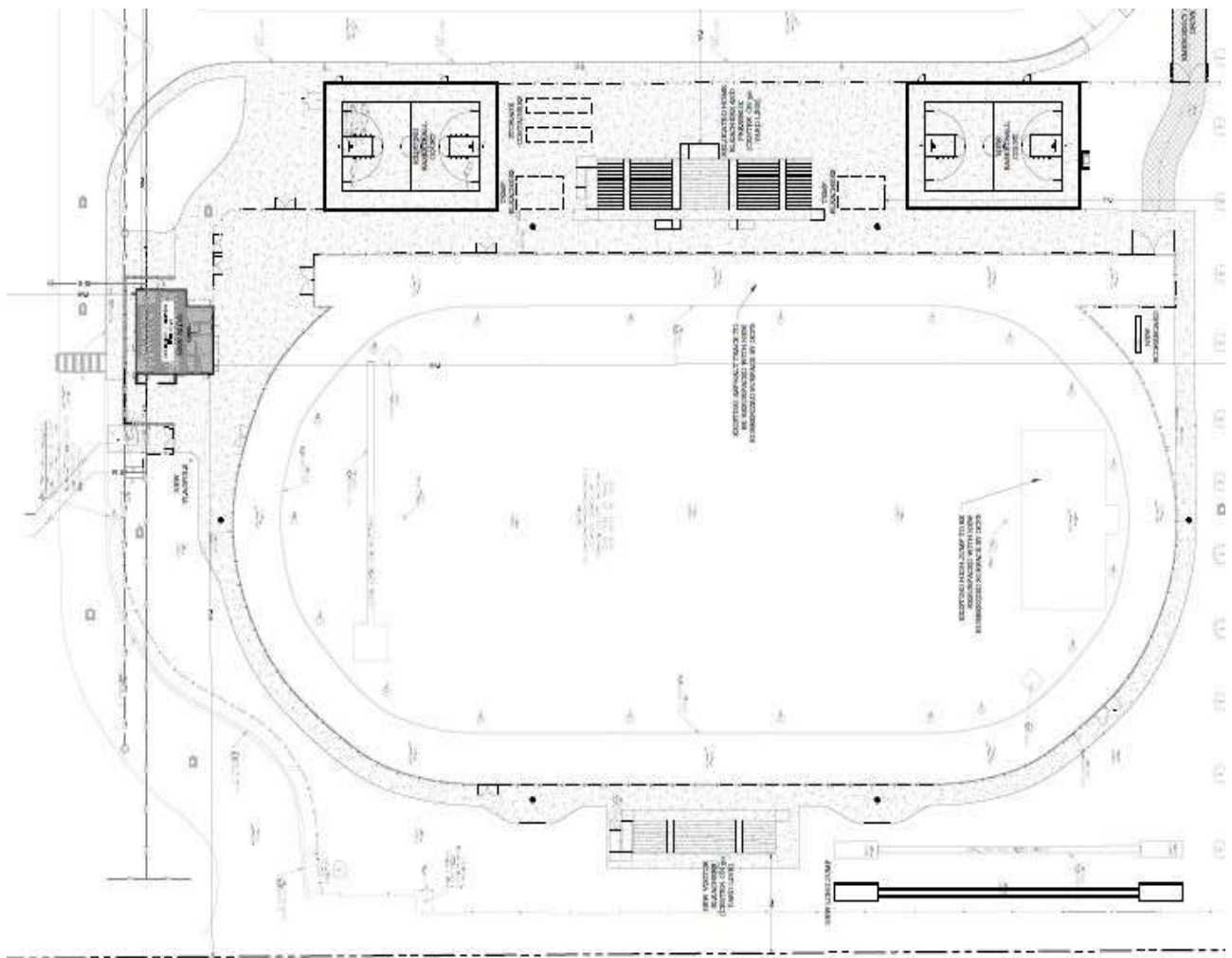

## Capital Construction Update as of April 18, 2024

We currently have 27 projects in the planning or design phase:

### Planning

- Site 126-E-W-4 (Relief)
- Site 136-A-E-5 (NE Maintenance) (Replacement)
- Boone HS (Comprehensive)
- Chain of Lakes MS (Comprehensive)
- Cherokee School (Repurpose)
- Clarcona ES (Old) Demolition (Repurpose)
- Esteem Academy (Repurpose)
- Jones HS (Comprehensive)
- Kaley ESE Services (Multi-System Renewal)
- Oakshire ES (Comprehensive)
- Ocoee MS (Comprehensive)
- Odyssey MS (Comprehensive)
- Olympia HS (Comprehensive)
- Palmetto ES (Comprehensive)
- Timber Creek HS (Comprehensive)

### Design

- Site 97-E-SE-2 ICP/West Innovation Way Area ES (Greenfield School)
- Site 121-A-W-7 West Bus Compound (Repurpose)
- Colonial HS (Comprehensive)
- FY22 Multi-Site (Comprehensive)
- Lawton Chiles ES (Comprehensive)
- NorthLake Park ES (Comprehensive)
- Oak Ridge HS (HS Functional Equity)
- Orange Technical College / South Campus (Mid-Florida) (Comprehensive)
- SY 2024-25 (Four ES Sites) (ES Functional Equity)
- SY 2024-25 (Four MS Sites) (MS Functional Equity)
- Three Points ES (Comprehensive)
- Winter Park HS (Comprehensive)

## Capital Construction Update as of April 18, 2024

### Since Last Report

- Substantial Completion achieved: **OTC Orlando**
- Notice to Proceed issued: **Nothing to Report**

### Closeout

- Water Spring MS (Capital Project)

## **Capital Renewal Update as of April 18, 2024**

There are 67 active projects (38 large, 20 intermediate, 9 small) currently in progress for improvements at 131 sites.

### **Planning**

We currently have 19 projects in planning at 81 sites. These include 8 large projects, 10 intermediate projects, and 1 small project.

Since the last report, four new projects commenced planning: Roofing replacement at Hunter's Creek MS; Auditorium refresh at 4 campuses; Exterior painting at 18 campuses; and Carpet replacement at Washington Shores PLC.

Also, one project moved to design and another to construction: Exterior painting at 7 campuses and Fire alarm replacement at Riverside ES respectively.

### **Design**

We currently have 20 projects in design at 57 sites. These include 17 large and 3 intermediate projects.

Since the last report, an Exterior painting project at 7 campuses moved to construction.

### **Construction**

We currently have 28 projects in construction at 84 sites. These include 13 large, 7 intermediate, and 8 small projects.

Since the last report, a new Café stage lighting replacement project at Southwest MS and a Fire alarm replacement project at Riverside ES commenced construction.

Additionally, a Chiller replacement project at 2 sites moved to close-out.

## **Capital Renewal Update as of April 18, 2024**

### **Changes since November March 21, 2024**

#### **Planning**

- New Projects
  - o Hunter's Creek MS Roofing – N0215.0
  - o FY24 Multi-Site Auditorium Refresh – N0212.0
  - o FY24 Multi-Site Exterior Painting – N0216.0
  - o Washington Shores PLC Carpet Replacement – N0213.0
- Moved to Design
  - o FY23 Multi-Site Exterior Painting – N0176.0
- Moved to Construction
  - o Riverside ES Fire Alarm Replacement – N0195.0

#### **Design**

- Moved from Planning
  - o FY23 Multi-Site Exterior Painting – N0176.0

#### **Construction**

- New Project
  - o Southwest MS Café Stage Lighting Replacement – N0209.0
- Moved from Planning
  - o Riverside ES Fire Alarm Replacement – N0195.0
- Moved to Close-out
  - o Chiller Replacement at 2-Sites – N0101.0

#### **Close-out**

- Moved from Construction
  - o Chiller Replacement at 2-Sites – N0101.0
- Moved to Closed
  - o Chain of Lakes MS HVAC – N0076.1
  - o FY22 Low Voltage CCTV at 18-Sites – N0158.0

## **Capital Renewal Update as of April 18, 2024**

### **Active Projects with Construction Cost Exceeding \$10M per Project Site**

#### **Apopka High School – Multi-System Capital Renewal Project Estimated Guaranteed Maximum Price: \$16,895,000**

##### **Site**

- Replacement of pumps and control panel at lift stations

##### **Exterior**

- Repair and replacement of exterior (EIFS) wall system in select areas
- Reroofing of select buildings

##### **Heating, Ventilating and Air Conditioning (HVAC) Renovations**

- Refurbishment of existing air handling units (AHUs) and the addition of bi-polar ionization
- Replacement of the existing building automation system (BAS) components
- Replacement of exhaust fans, outside air dampers, variable frequency drives (VFDs), electric heating coils, and selected variable air volume (VAV) boxes
- Selective replacement of Dx and mini-split A/C units and connection to the BAS controls

##### **Electrical**

- Electrical power modifications/upgrades to support the HVAC system design
- Repair of lightning protection system
- Replacement of parking lot light fixtures with LED type fixtures

##### **Life Safety**

- Replacement of fire alarm system

## **Capital Renewal Update as of April 18, 2024**

### **Active Projects with Construction Cost Exceeding \$10M per Project Site**

#### **Bonneville Elementary School – Multi-System Capital Renewal Project Guaranteed Maximum Price: \$10,303,515**

##### **Site**

- New underground storm piping
- Canopy removal to accommodate underground storm piping

##### **Exterior**

- Reroofing of select buildings

##### **Heating, Ventilating and Air Conditioning (HVAC) Renovations**

- Replacement of existing air handling units (AHUs) and the addition of bi-polar ionization
- Replacement of roof top units (RTU), packaged terminal air conditioning (PTAC) units, exhaust fans, gravity vents, kitchen exhaust fan, split systems, fan coil units (FCU), variable air volume (VAV) boxes, and make up air unit

##### **Chiller Replacement**

- Replacement of existing chillers and associated pumps, piping, and equipment

##### **Electrical**

- Electrical power modifications/upgrades to support the HVAC system design
- Campus wide lighting upgrades

## **Capital Renewal Update as of April 18, 2024**

### **Active Projects with Construction Cost Exceeding \$10M per Project Site**

#### **Ocoee High School – Chiller Replacement-HVAC Capital Renewal Project Estimated Guaranteed Maximum Price: \$24,196,000**

##### **Heating, Ventilating and Air Conditioning (HVAC) Renovations**

- Replacement of existing air handling units (AHUs) and the addition of bi-polar ionization
- Replacement of the existing building automation system (BAS), campus-wide
- Refurbishment of mechanical rooms, including replacement of gauges, sensors, valves and other appurtenances and restoration of insulation
- Replacement of exhaust fans, outside air dampers, variable frequency drives (VFDs), electric heating coils
- Replacement of all variable air volume (VAV) boxes
- Equipment resizing and reengineered air flow requirements
- Selective replacement of ductwork to accommodate the new design
- Selective replacement of Dx and mini-split A/C units

##### **Chiller Replacement**

- Replacement of existing chillers, cooling towers, and associated pumps, piping, and equipment with magnetic bearing chillers
- Replacement of existing controls
- Equipment resizing based on load modifications
- Provision of a new refrigerant leak detection system

##### **Electrical**

- Electrical power modifications/upgrades to support the HVAC system design and new air-cooled chillers
- Reuse of existing feeders or breakers and replacement as needed



## **Capital Renewal Update as of April 18, 2024**

### **Active Projects with Construction Cost Exceeding \$10M per Project Site**

#### **Piedmont Lakes Middle School – Mechanical-HVAC Capital Renewal Project Estimated Guaranteed Maximum Price: \$15,700,000**

##### **Heating, Ventilating and Air Conditioning (HVAC) Renovations**

- Replacement of the existing building automation system (BAS), campus-wide
- Redesign of a new Air Distribution System campus-wide per the latest Design Guidelines inclusive of all associated equipment and accessories
- Conversion of kitchen units from Direct Expansion Cooling (Dx) to Chilled Water
- Replacement of existing wall mounted mini-split system in select areas
- Evaluation of all IDF and CCTV rooms current heat load requirements to include with the new Air Distribution System

##### **Plumbing**

- Replacement of approximately 400 LF of underground sanitary sewer line
- Replacement of all hot water heaters

##### **Electrical**

- Installation of power and data ports for building automation system (BAS) interconnectivity and new electrical circuitry as required to support all new equipment installation

##### **Interior**

- Replacement of finishes as needed to accommodate new design

## **Capital Renewal Update as of April 18, 2024**

### **Active Projects with Construction Cost Exceeding \$10M per Project Site**

#### **Roberto Clemente Middle School – Multi-System Capital Renewal Project Guaranteed Maximum Price: \$ 16,241,416**

##### **Site**

- Correcting drainage issues campus-wide

##### **Roofing**

- Roof replacement of buildings 100, 200, 300, 400 and 700
- Roof repairs of building 500

##### **Exterior**

- Select door replacement
- Replace exterior door and window seals

##### **Interior**

- Select door replacement
- Replacement of finishes as needed to accommodate new design
- Replacement of serving line equipment

##### **Heating, Ventilating and Air Conditioning (HVAC) Renovations**

- Replace HVAC system equipment in buildings 100, 200, 300, and 500
- Refurbishment of HVAC system in other buildings
- Replacement of the existing building automation system (BAS), campus-wide

##### **Plumbing**

- Reconfigure restrooms in building 700 for ADA compliance

##### **Electrical & Systems**

- Electrical upgrades necessary for HVAC work
- Exterior lighting upgrades to LED
- Lighting LED upgrade in select buildings
- Intercom system replacement for entire campus
- Intrusion detection and security CCTV upgrades campus-wide

##### **Life Safety**

- Fire alarm system interconnection upgrade to fiber

## **Capital Renewal Update as of April 18, 2024**

### **Active Projects with Construction Cost Exceeding \$10M per Project Site**

#### **West Orange High School – HVAC Renovation-HVAC Capital Renewal Project Estimated Guaranteed Maximum Price: \$10,300,000**

##### **Heating, Ventilating and Air Conditioning (HVAC) Renovations**

- Refurbishment or replacement of existing air handling units (AHUs) and the addition of bi-polar ionization
- Replacement of the existing building automation system (BAS) controls, campus-wide
- Refurbishment of mechanical rooms, including replacement of gauges, sensors, valves and pumps
- Replacement of exhaust fans, outside air dampers, variable frequency drives (VFDs), electric heating coils, and selected variable air volume (VAV) boxes
- Selective replacement of Dx and mini-split A/C units

##### **Electrical**

- Electrical power modifications/upgrades to support the HVAC system design
- Reuse of existing feeders or breakers, lightning protection system and replacement as needed

**CHANGE ORDER REPORT**

# Change Order Report

---

Facilities & Construction Contracting  
February 2024

PROJECT NAME	VENDOR NAME	DOCUMENT TYPE	ORIGINAL DOC NO.	AM GMP NO.	DOC NO.	REQUESTED AMOUNT	REASON FOR CHANGE	APPROVAL REQUIREMENT
Orange Technical College	Gilbane Building Company	Change Order	19CM04SCON GILBANE	1	3	\$208,088.45	Cost to construct parking lot improvements including, but not limited to, removing, and replacing existing curbing, island modifications, additional milling, asphalt, grading, modifications to ramp, and striping for comprehensive project.	Board (02/13/24) / Rory A. Salimbene, Chief Facilities Officer

There are no significant Amendments to the report for the month of February 2024.

Facilities & Construction Contracting

COVE Report for February 2024

CONTRACTS AMENDED										
ITEM NO.	PROJECT NAME	VENDOR NAME	DOCUMENT TYPE	ORIGINAL DOC No.	DOC No.	REQUESTED AMOUNT	SERVICE TYPE	RFQ No.	REASON FOR CHANGE	APPROVAL REQUIREMENT
1	District-Wide	Brindley Pieters & Associates, Inc.	Amendment	1515CCON BRINDLEY	6	\$0.00	Civil Engineering Services	1515PS	Modification to Staffing Schedule to add sub-consultant - CHP for civil engineering continuing contract.	Catherine Sullivan, Sr. Facilities Manager, Design
2	District-Wide	Baker Barrios Architects, Inc.	Amendment	1910CCON BAKER	4	\$0.00	Architectural & Engineering Services	1910PS	Modifications to contract language to remove "per Project/Location" from professional liability in the insurance section for architectural and engineering services continuing contract.	K. Michael Winter, Facilities Executive Director
3	District-Wide	DLR Group, Inc.	Amendment	1910CCON DLR	2	\$0.00	Architectural & Engineering Services	1910PS	Modifications to contract language to remove "per Project/Location" from professional liability in the insurance section for architectural and engineering services continuing contract.	K. Michael Winter, Facilities Executive Director
4	District-Wide	GatorSkitch Corporation	Amendment	1910CCON GATOR	2	\$0.00	Architectural & Engineering Services	1910PS	Modifications to contract language to remove "per Project/Location" from professional liability in the insurance section for architectural and engineering services continuing contract.	K. Michael Winter, Facilities Executive Director
5	District-Wide	Harvard Jolly, Inc.	Amendment	1910CCON HARVARD	2	\$0.00	Architectural & Engineering Services	1910PS	Modifications to contract language to remove "per Project/Location" from professional liability in the insurance section for architectural and engineering services continuing contract.	K. Michael Winter, Facilities Executive Director
6	District-Wide	Little Diversified Architectural Consulting	Amendment	1910CCON LITTLE	2	\$0.00	Architectural & Engineering Services	1910PS	Modifications to contract language to remove "per Project/Location" from professional liability in the insurance section for architectural and engineering services continuing contract.	K. Michael Winter, Facilities Executive Director

Facilities & Construction Contracting

COVE Report for February 2024

CONTRACTS AMENDED										
ITEM NO.	PROJECT NAME	VENDOR NAME	DOCUMENT TYPE	ORIGINAL DOC No.	DOC No.	REQUESTED AMOUNT	SERVICE TYPE	RFQ No.	REASON FOR CHANGE	APPROVAL REQUIREMENT
7	District-Wide	MLM-Martin Architects, Inc.	Amendment	1910CCON MLM	3	\$0.00	Architectural & Engineering Services	1910PS	Modifications to contract language to remove "per Project/Location" from professional liability in the insurance section for architectural and engineering services continuing contract.	K. Michael Winter, Facilities Executive Director
8	District-Wide	Rhodes & Brito Architects, Inc.	Amendment	1910CCON RHODES	2	\$0.00	Architectural & Engineering Services	1910PS	Modifications to contract language to remove "per Project/Location" from professional liability in the insurance section for architectural and engineering services continuing contract.	K. Michael Winter, Facilities Executive Director
9	District-Wide	Song & Associates, Inc.	Amendment	1910CCON SONG	2	\$0.00	Architectural & Engineering Services	1910PS	Modifications to contract language to remove "per Project/Location" from professional liability in the insurance section for architectural and engineering services continuing contract.	K. Michael Winter, Facilities Executive Director
10	District-Wide	ICE East, LLC	Amendment	1911CCON ICE	2	\$0.00	Commissioning Services	1911PS	Modifications to contract language to remove "per Project/Location" from professional liability in the insurance section for commissioning services continuing contract.	K. Michael Winter, Facilities Executive Director
11	District-Wide	Matern Professional Engineering, Inc.	Amendment	1911CCON MATERN	2	\$0.00	Commissioning Services	1911PS	Modifications to contract language to remove "per Project/Location" from professional liability in the insurance section for commissioning services continuing contract.	K. Michael Winter, Facilities Executive Director



Facilities & Construction Contracting

COVE Report for February 2024

CONTRACTS AMENDED										
ITEM NO.	PROJECT NAME	VENDOR NAME	DOCUMENT TYPE	ORIGINAL DOC No.	DOC No.	REQUESTED AMOUNT	SERVICE TYPE	RFQ No.	REASON FOR CHANGE	APPROVAL REQUIREMENT
12	District-Wide	SGM Engineering, Inc.	Amendment	1911CCON SGM	3	\$0.00	Commissioning Services	1911PS	Modifications to contract language to remove "per Project/Location" from professional liability in the insurance section for commissioning services continuing contract.	K. Michael Winter, Facilities Executive Director
13	District-Wide	TLC Engineering Solutions, Inc.	Amendment	1911CCON TLC	2	\$0.00	Commissioning Services	1911PS	Modifications to contract language to remove "per Project/Location" from professional liability in the insurance section for commissioning services continuing contract.	K. Michael Winter, Facilities Executive Director
14	District-Wide	TriStar Engineering Group, Inc.	Amendment	1911CCON TRISTAR	2	\$0.00	Commissioning Services	1911PS	Modifications to contract language to remove "per Project/Location" from professional liability in the insurance section commissioning services continuing contract.	K. Michael Winter, Facilities Executive Director
15	District-Wide	Sequel Developers, Inc.	Amendment	19CM09CCON SEQUEL	3	\$0.00	Construction Management Services	19CM09	Staffing schedule modification to add project engineer for continuing contract.	Craig A. Jackson, Sr. Construction Director
16	District-Wide	AECOM Technical Services Inc.	Amendment	21PM28CON AECOM	11	\$0.00	Program Management Support Services	21PM28	Modifications of Staffing Plan and Salary Schedule to provide program management services to support annual program project and meet general responsibilities requirements for period 3/1/2023 to 2/29/2024 for the program management contract.	K. Michael Winter, Facilities Executive Director
17	District-Wide	AVCON, Inc.	Amendment	2202PS-CCON001 AVCON	1	\$0.00	Structural Engineering Services	2202PS	Modifications to contract language to remove "per Project/Location" from professional liability in the insurance section for structural engineering services continuing contract.	K. Michael Winter, Facilities Executive Director

Facilities & Construction Contracting

COVE Report for February 2024

CONTRACTS AMENDED										
ITEM NO.	PROJECT NAME	VENDOR NAME	DOCUMENT TYPE	ORIGINAL DOC No.	DOC No.	REQUESTED AMOUNT	SERVICE TYPE	RFQ No.	REASON FOR CHANGE	APPROVAL REQUIREMENT
18	District-Wide	GRAEF-USA, Inc.	Amendment	2202PS-CCON001 GRAEF	1	\$0.00	Structural Engineering Services	2202PS	Modifications to contract language to remove "per Project/ Location" from professional liability in the insurance section for structural engineering services continuing contract.	K. Michael Winter, Facilities Executive Director
19	District-Wide	AVCON, Inc.	Amendment	2202PS-CCON002 AVCON	1	\$0.00	Structural Engineering Services	2202PS	Modifications to contract language to remove "per Project/Location" from professional liability in the insurance section for structural engineering services continuing contract.	K. Michael Winter, Facilities Executive Director
20	District-Wide	GRAEF-USA, Inc.	Amendment	2202PS-CCON002 GRAEF	1	\$0.00	Structural Engineering Services	2202PS	Modifications to contract language to remove "per Project/ Location" from professional liability in the insurance section for structural engineering services continuing contract.	K. Michael Winter, Facilities Executive Director
21	District-Wide	A/R/C Associates, Inc.	Amendment	2203PS-CCON001 ARC	1	\$0.00	Building Envelope Consultant Services	2203PS	Modifications to contract language to remove "per Project/Location" from professional liability in the insurance section for building envelope continuing contract.	K. Michael Winter, Facilities Executive Director
22	District-Wide	Gale Associates \South\, Inc.	Amendment	2203PS-CCON001 GALE	1	\$0.00	Building Envelope Consultant Services	2203PS	Modifications to contract language to remove "per Project/Location" from professional liability in the insurance section for building envelope continuing contract.	K. Michael Winter, Facilities Executive Director
23	District-Wide	Jay Ammon Architect, Inc.	Amendment	2203PS-CCON001 JAY	1	\$0.00	Building Envelope Consultant Services	2203PS	Modifications to contract language to remove "per Project/Location" from professional liability in the insurance section for building envelope continuing contract.	K. Michael Winter, Facilities Executive Director

Facilities & Construction Contracting

COVE Report for February 2024

CONTRACTS AMENDED										
ITEM NO.	PROJECT NAME	VENDOR NAME	DOCUMENT TYPE	ORIGINAL DOC No.	DOC No.	REQUESTED AMOUNT	SERVICE TYPE	RFQ No.	REASON FOR CHANGE	APPROVAL REQUIREMENT
24	District-Wide	NOVA Engineering and Environmental, LLC	Amendment	2203PS-CCON001 NOVA	1	\$0.00	Building Envelope Consultant Services	2203PS	Modifications to contract language to remove "per Project/Location" from professional liability in the insurance section for building envelope continuing contract.	K. Michael Winter, Facilities Executive Director
25	District-Wide	A/R/C Associates, Inc.	Amendment	2203PS-CCON002 ARC	1	\$0.00	Building Envelope Consultant Services	2203PS	Modifications to contract language to remove "per Project/Location" from professional liability in the insurance section for building envelope continuing contract.	K. Michael Winter, Facilities Executive Director
26	District-Wide	Gale Associates \South\, Inc.	Amendment	2203PS-CCON002 GALE	1	\$0.00	Building Envelope Consultant Services	2203PS	Modifications to contract language to remove "per Project/Location" from professional liability in the insurance section for building envelope continuing contract.	K. Michael Winter, Facilities Executive Director
27	District-Wide	Jay Ammon Architect, Inc.	Amendment	2203PS-CCON002 JAY	1	\$0.00	Building Envelope Consultant Services	2203PS	Modifications to contract language to remove "per Project/Location" from professional liability in the insurance section for building envelope continuing contract.	K. Michael Winter, Facilities Executive Director
28	District-Wide	NOVA Engineering and Environmental, LLC	Amendment	2203PS-CCON002 NOVA	1	\$0.00	Building Envelope Consultant Services	2203PS	Modifications to contract language to remove "per Project/Location" from professional liability in the insurance section for building envelope continuing contract.	K. Michael Winter, Facilities Executive Director
29	District-Wide	AVCON, Inc.	Amendment	2223PS-CCON001 AVCON	1	\$0.00	Mechanical, Electrical & Plumbing Engineering Services	2223PS	Modifications to contract language to remove "per Project/Location" for professional liability in the insurance section for mechanical, electrical, and plumbing engineering services continuing contract.	K. Michael Winter, Facilities Executive Director

Facilities & Construction Contracting

COVE Report for February 2024

CONTRACTS AMENDED										
ITEM NO.	PROJECT NAME	VENDOR NAME	DOCUMENT TYPE	ORIGINAL DOC No.	DOC No.	REQUESTED AMOUNT	SERVICE TYPE	RFQ No.	REASON FOR CHANGE	APPROVAL REQUIREMENT
30	District-Wide	Bobes Associates Consulting Engineers, Inc.	Amendment	2223PS-CCON001 BOBES	1	\$0.00	Mechanical, Electrical & Plumbing Engineering Services	2223PS	Modifications to contract language to remove "per Project/Location" for professional liability in the insurance section for mechanical, electrical, and plumbing engineering services continuing contract.	K. Michael Winter, Facilities Executive Director
31	District-Wide	GRAEF-USA, Inc.	Amendment	2223PS-CCON001 GRAEF	1	\$0.00	Mechanical, Electrical & Plumbing Engineering Services	2223PS	Modifications to contract language to remove "per Project/Location" for professional liability in the insurance section for mechanical, electrical, and plumbing engineering services continuing contract.	K. Michael Winter, Facilities Executive Director
32	District-Wide	Matern Professional Engineering, Inc.	Amendment	2223PS-CCON001 MATERN	1	\$0.00	Mechanical, Electrical & Plumbing Engineering Services	2223PS	Modifications to contract language to remove "per Project/Location" for professional liability in the insurance section for mechanical, electrical, and plumbing engineering services continuing contract.	K. Michael Winter, Facilities Executive Director
33	District-Wide	RGD Consulting Engineers Orlando, LLC	Amendment	2223PS-CCON001 RGD	1	\$0.00	Mechanical, Electrical & Plumbing Engineering Services	2223PS	Modifications to contract language to remove "per Project/Location" for professional liability in the insurance section for mechanical, electrical, and plumbing engineering services continuing contract.	K. Michael Winter, Facilities Executive Director
34	District-Wide	SGM Engineering, Inc.	Amendment	2223PS-CCON001 SGM	1	\$0.00	Mechanical, Electrical & Plumbing Engineering Services	2223PS	Modifications to contract language to remove "per Project/Location" for professional liability in the insurance section for mechanical, electrical, and plumbing engineering services continuing contract.	K. Michael Winter, Facilities Executive Director

Facilities & Construction Contracting

COVE Report for February 2024

CONTRACTS AMENDED										
ITEM NO.	PROJECT NAME	VENDOR NAME	DOCUMENT TYPE	ORIGINAL DOC No.	DOC No.	REQUESTED AMOUNT	SERVICE TYPE	RFQ No.	REASON FOR CHANGE	APPROVAL REQUIREMENT
35	District-Wide	AVCON, Inc.	Amendment	2223PS-CCON002 AVCON	1	\$0.00	Mechanical, Electrical & Plumbing Engineering Services	2223PS	Modifications to contract language to remove “per Project/Location” for professional liability in the insurance section for mechanical, electrical, and plumbing engineering services continuing contract.	K. Michael Winter, Facilities Executive Director
36	District-Wide	Bobes Associates Consulting Engineers, Inc.	Amendment	2223PS-CCON002 BOBES	1	\$0.00	Mechanical, Electrical & Plumbing Engineering Services	2223PS	Modifications to contract language to remove “per Project/Location” for professional liability in the insurance section for mechanical, electrical, and plumbing engineering services continuing contract.	K. Michael Winter, Facilities Executive Director
37	District-Wide	GRAEF-USA, Inc.	Amendment	2223PS-CCON002 GRAEF	1	\$0.00	Mechanical, Electrical & Plumbing Engineering Services	2223PS	Modifications to contract language to remove “per Project/Location” for professional liability in the insurance section for mechanical, electrical, and plumbing engineering services continuing contract.	K. Michael Winter, Facilities Executive Director
38	District-Wide	Matern Professional Engineering, Inc.	Amendment	2223PS-CCON002 MATERN	1	\$0.00	Mechanical, Electrical & Plumbing Engineering Services	2223PS	Modifications to contract language to remove “per Project/Location” for professional liability in the insurance section for mechanical, electrical, and plumbing engineering services continuing contract.	K. Michael Winter, Facilities Executive Director
39	District-Wide	RGD Consulting Engineers Orlando, LLC	Amendment	2223PS-CCON002 RGD	1	\$0.00	Mechanical, Electrical & Plumbing Engineering Services	2223PS	Modifications to contract language to remove “per Project/Location” for professional liability in the insurance section for mechanical, electrical, and plumbing engineering services continuing contract.	K. Michael Winter, Facilities Executive Director

Facilities & Construction Contracting

COVE Report for February 2024

CONTRACTS AMENDED										
ITEM NO.	PROJECT NAME	VENDOR NAME	DOCUMENT TYPE	ORIGINAL DOC No.	DOC No.	REQUESTED AMOUNT	SERVICE TYPE	RFQ No.	REASON FOR CHANGE	APPROVAL REQUIREMENT
40	District-Wide	SGM Engineering, Inc.	Amendment	2223PS-CCON002 SGM	1	\$0.00	Mechanical, Electrical & Plumbing Engineering Services	2223PS	Modifications to contract language to remove "per Project/Location" for professional liability in the insurance section for mechanical, electrical, and plumbing engineering services continuing contract.	K. Michael Winter, Facilities Executive Director
41	District-Wide	AVCON, Inc.	Amendment	2227PS-CCON001 AVCON	1	\$0.00	Civil Engineering Services	2227PS	Modifications to contract language to remove "per Project/Location" from professional liability in the insurance section for civil engineering continuing contract.	K. Michael Winter, Facilities Executive Director
42	District-Wide	DAO Consultants, Inc.	Amendment	2227PS-CCON001 DAO	1	\$0.00	Civil Engineering Services	2227PS	Modifications to contract language to remove "per Project/Location" from for Professional Liability in Insurance section for civil engineering continuing contract.	K. Michael Winter, Facilities Executive Director
43	District-Wide	Gale Associates \South\, Inc.	Amendment	2227PS-CCON001 GALE	1	\$0.00	Civil Engineering Services	2227PS	Modifications to contract language to remove "per Project/Location" from professional liability in the insurance section for civil engineering continuing contract.	K. Michael Winter, Facilities Executive Director
44	District-Wide	Klima Weeks Civil Engineering, Inc.	Amendment	2227PS-CCON001 KLIMA	1	\$0.00	Civil Engineering Services	2227PS	Modifications to contract language to remove "per Project/Location" from professional liability in the insurance section for civil engineering continuing contract.	K. Michael Winter, Facilities Executive Director

Facilities & Construction Contracting

COVE Report for February 2024

CONTRACTS AMENDED										
ITEM NO.	PROJECT NAME	VENDOR NAME	DOCUMENT TYPE	ORIGINAL DOC No.	DOC No.	REQUESTED AMOUNT	SERVICE TYPE	RFQ No.	REASON FOR CHANGE	APPROVAL REQUIREMENT
45	District-Wide	AVCON, Inc.	Amendment	2227PS-CCON002 AVCON	1	\$0.00	Civil Engineering Services	2227PS	Modifications to contract language to remove "per Project/Location" from professional liability in the insurance section for civil engineering continuing contract.	K. Michael Winter, Facilities Executive Director
46	District-Wide	DAO Consultants, Inc.	Amendment	2227PS-CCON002 DAO	1	\$0.00	Civil Engineering Services	2227PS	Modifications to contract language to remove "per Project/Location" from professional liability in the insurance section for civil engineering continuing contract.	K. Michael Winter, Facilities Executive Director
47	District-Wide	Gale Associates \South\, Inc.	Amendment	2227PS-CCON002 GALE	1	\$0.00	Civil Engineering Services	2227PS	Modifications to contract language to remove "per Project/Location" from professional liability in the insurance section for civil engineering continuing contract.	K. Michael Winter, Facilities Executive Director
48	District-Wide	Klima Weeks Civil Engineering, Inc.	Amendment	2227PS-CCON002 KLIMA	1	\$0.00	Civil Engineering Services	2227PS	Modifications to contract language to remove "per Project/Location" from professional liability in the insurance section for civil engineering continuing contract.	K. Michael Winter, Facilities Executive Director
49	District-Wide	ECS Florida, LLC	Amendment	2228PS-CCON ECS	1	\$0.00	Geotechnical, Environmental & Construction Material Testing Services	2228PS	Modifications to contract language to remove "per Project/Location" from professional liability in the insurance section for geotechnical, environmental, and construction material testing continuing contract.	K. Michael Winter, Facilities Executive Director



Facilities & Construction Contracting

COVE Report for February 2024

CONTRACTS AMENDED										
ITEM NO.	PROJECT NAME	VENDOR NAME	DOCUMENT TYPE	ORIGINAL DOC No.	DOC No.	REQUESTED AMOUNT	SERVICE TYPE	RFQ No.	REASON FOR CHANGE	APPROVAL REQUIREMENT
50	District-Wide	NOVA Engineering and Environmental, LLC	Amendment	2228PS-CCON NOVA	1	\$0.00	Geotechnical, Environmental & Construction Material Testing Services	2228PS	Modifications to contract language to remove "per Project/Location" from professional liability in the insurance section for geotechnical, environmental, and construction material testing continuing contract.	K. Michael Winter, Facilities Executive Director
51	District-Wide	NV5, Inc.	Amendment	2228PS-CCON NV5	1	\$0.00	Geotechnical, Environmental & Construction Material Testing Services	2228PS	Modification of Staffing Schedule to replace Contract Manager and modifications of contract language to remove "per Project/Location" from for professional liability in insurance section for geotechnical, environmental and construction material testing, continuing contract.	K. Michael Winter, Facilities Executive Director
52	District-Wide	Professional Service Industries, Inc.	Amendment	2228PS-CCON PROFESSIONAL	1	\$0.00	Geotechnical, Environmental & Construction Material Testing Services	2228PS	Modifications to contract language to remove "per Project/Location" from professional liability in the insurance section for geotechnical, environmental, and construction material testing, continuing contract.	K. Michael Winter, Facilities Executive Director
53	District-Wide	Terracon Consultants, Inc.	Amendment	2228PS-CCON TERRACON	1	\$0.00	Geotechnical, Environmental & Construction Material Testing Services	2228PS	Modifications to contract language to remove "per Project/Location" from professional liability in the insurance section for geotechnical, environmental, and construction material testing continuing contract.	K. Michael Winter, Facilities Executive Director

Facilities & Construction Contracting

COVE Report for February 2024

CONTRACTS AMENDED										
ITEM NO.	PROJECT NAME	VENDOR NAME	DOCUMENT TYPE	ORIGINAL DOC No.	DOC No.	REQUESTED AMOUNT	SERVICE TYPE	RFQ No.	REASON FOR CHANGE	APPROVAL REQUIREMENT
54	District-Wide	Tierra, Inc.	Amendment	2228PS-CCON TIERRA	1	\$0.00	Geotechnical, Environmental & Construction Material Testing Services	2228PS	Modifications to contract language to remove "per Project/Location" from professional liability in the insurance section for geotechnical, environmental, and construction material testing services continuing contract.	K. Michael Winter, Facilities Executive Director
55	District-Wide	Echo UES, Inc.	Amendment	2229PS-CCON ECHO	1	\$0.00	Surveying Services	2229PS	Modifications to contract language to remove "per Project/Location" from professional liability in the insurance section for surveying continuing contract.	K. Michael Winter, Facilities Executive Director
56	District-Wide	Leading Edge Land Services, Inc.	Amendment	2229PS-CCON LEADING	1	\$0.00	Surveying Services	2229PS	Modifications to contract language to remove "per Project/Location" from professional liability in the insurance section for surveying continuing contract.	K. Michael Winter, Facilities Executive Director
57	District-Wide	L&S Diversified, LLC	Amendment	2229PS-CCON L-S	1	\$0.00	Surveying Services	2229PS	Modifications to contract language to remove "per Project/Location" from professional liability in the insurance section for surveying continuing contract.	K. Michael Winter, Facilities Executive Director
58	District-Wide	Southeastern Surveying & Mapping Corporation	Amendment	2229PS-CCON SOUTHEASTERN	1	\$0.00	Surveying Services	2229PS	Modifications to contract language to remove "per Project/Location" from professional liability in the insurance section for surveying continuing contract.	K. Michael Winter, Facilities Executive Director
59	District-Wide	T2 UES, Inc. dba T2 Utility Engineers	Amendment	2229PS-CCON T2	1	\$0.00	Surveying Services	2229PS	Modifications to contract language to remove "per Project/Location" from professional liability in the insurance section for surveying continuing contract.	K. Michael Winter, Facilities Executive Director

Facilities & Construction Contracting

COVE Report for February 2024

CONTRACTS AMENDED										
ITEM NO.	PROJECT NAME	VENDOR NAME	DOCUMENT TYPE	ORIGINAL DOC No.	DOC No.	REQUESTED AMOUNT	SERVICE TYPE	RFQ No.	REASON FOR CHANGE	APPROVAL REQUIREMENT
60	District-Wide	WSP USA Inc.	Amendment	2229PS-CCON WSP	1	\$0.00	Surveying Services	2229PS	Modifications to contract language to remove "per Project/Location" from professional liability in the insurance section for surveying continuing contract.	K. Michael Winter, Facilities Executive Director
61	District-Wide	Gallagher Bassett Services, Inc.	Amendment	2311PS-CCON GALLAGHER	1	\$0.00	Environmental Consulting Services	2311PS	Modifications to contract language to remove the "per Project/Location" from for Professional Liability in the Insurance section for environmental consulting continuing contract.	Jennifer Fowler, Sr. Director Environmental Compliance and Sustainability
62	District-Wide	GLE Associates, Inc.	Amendment	2311PS-CCON GLE	1	\$0.00	Environmental Consulting Services	2311PS	Modifications to contract language to remove the "per Project/Location" from for Professional Liability in the Insurance section for environmental consulting continuing contract.	Jennifer Fowler, Sr. Director Environmental Compliance and Sustainability
63	District-Wide	Universal Engineering Sciences, Inc.	Amendment	2311PS-CCON UNIVERSAL	1	\$0.00	Environmental Consulting Services	2311PS	Modifications to contract language to remove the "per Project/Location" from for Professional Liability in the Insurance section for environmental consulting continuing contract.	Jennifer Fowler, Sr. Director Environmental Compliance and Sustainability
64	Elementary School Site 126-E-4 *	Ardaman & Associates, Inc.	Amendment	1517357	1	\$452.03	Geotechnical & Environmental Services	1517PS	Additional wetland assessment and endangered species evaluation of Phase I Environmental Site Assessment Report due to standard diligence investigations for real property project.	Harold Jenkins, Director, Real Estate Management
65	Four Sites SY2024-25 Elementary School Classroom Additions	C. T. Hsu & Associates, LLC	Amendment	2131SCON CTHSU	6	\$0.00	Architectural & Engineering Services	2131PS	Contract modification to correct project name to "Four Sites SY2024-25 Elementary School Classroom Additions" due to scrivener's error for functional equity project.	Catherine Sullivan, Sr. Facilities Manager, Design

Facilities & Construction Contracting

COVE Report for February 2024

CONTRACTS AMENDED										
ITEM NO.	PROJECT NAME	VENDOR NAME	DOCUMENT TYPE	ORIGINAL DOC No.	DOC No.	REQUESTED AMOUNT	SERVICE TYPE	RFQ No.	REASON FOR CHANGE	APPROVAL REQUIREMENT
66	Four Sites SY2024-25 Middle School Classroom Additions	Thornton Construction Company, Inc.	Amendment	21CM30SCON THORNTON	1	\$0.00	Construction Management Services	21CM30	Contract modification to correct project name to "Four Sites SY2024-25 Elementary School Classroom Additions Project" due to scrivener's error for functional equity project.	Catherine Sullivan, Sr. Facilities Manager, Design
67	Four Sites SY2024-25 Elementary School Classroom Additions	C. T. Hsu & Associates, LLC	Amendment	2131SCON CTHSU	4	\$15,555.00	Architectural & Engineering Services	2131PS	Additional services for site surveying, underground utility locates, and four borings in conjunction with traffic signal mast designs at the intersection of Town Center Boulevard and Lord Barclay Drive at Hunter Creek ES and staffing modification to add two sub-consultants, Real Food Hospitality, Strategy and Design and Blood Hound for functional equity project (no additional Est. Constr. Cost).	Catherine Sullivan on behalf of Rory A. Salimbene, Chief Facilities Officer
68	Four Sites SY2024-25 Elementary School Classroom Additions	C. T. Hsu & Associates, LLC	Amendment	2131SCON CTHSU	5	\$34,626.00	Architectural & Engineering Services	2131PS	Additional services in the kitchen of Dr. Phillips ES to revise existing single serving line area into two serving lines with two points of sale for functional equity project using capital renewal funds (additional Est. Constr. Cost of \$300,000.00).	Rory A. Salimbene, Chief Facilities Officer
69	Windermere HS On-Campus Football Stadium	Schenkel & Shultz, Inc.	Design Change Directive	1910042	5	\$5,390.03	Architectural & Engineering Services	1910PS	Additional services for fencing and sidewalk to accommodate access and egress of spectators from the parking lot for site improvement project (additional Est. Constr. Cost of \$20,000.00).	Catherine Sullivan, Sr. Facilities Manager, Design

\*Not Funded by Sales Tax or Capital Renewal

Facilities & Construction Contracting

COVE Report for February 2024

CHANGE ORDERS APPROVED												
ITEM NO.	PROJECT NAME	VENDOR NAME	DOCUMENT TYPE	ORIGINAL DOC No.	AM GMP No.	DOC No.	REQUESTED AMOUNT	SERVICE TYPE	RFQ No.	REASON FOR CHANGE	ODP %	APPROVAL REQUIREMENT
1	Innovation HS 50-H-2	CORE Construction Services of Florida, LLC	Construction Change Directive	21CM07SCON CORE	6	3	\$0.00	Construction Management Services	21CM07	Use of up to \$4,449,800.00 of offsite improvement allowance (\$5,500,000.00) for road improvement for the new school relief project.		Craig A. Jackson, Sr. Construction Director
2	Orange Technical College	Gilbane Building Company	Change Order	19CM04SCON GILBANE	1	3	\$208,088.45	Construction Management Services	19CM04	Cost to construct parking lot improvements including, but not limited to, removing, and replacing existing curbing, island modifications, additional milling, asphalt, grading, modifications to ramp, and striping for comprehensive project.		Board (02/13/24) / Rory A. Salimbene, Chief Facilities Officer

\*Not Funded by Sales Tax or Capital Renewal

**OCPS FACILITIES & CONSTRUCTION CONTRACTING**

**RFQs in Progress: APRIL 2024**

No.	Contract Description	Pre Submittal Meeting	Open Date	Shortlist Meeting	Interview Meeting	Board / CFO Date	Construction Budget	Firm(s) Awarded	Status
RFQ 2401PS	A/E Services for Cherokee School of Arts and Entertainment Repurpose Project	4/10/2024	5/7/2024	5/21/2024	6/4/2024	6/25/2024	\$60,000,000.00		On-Going

**SALES TAX REFERENDUM STATUTES AND LANGUAGE**

**FACILITIES BOARD WORKSHOP PREVIEW**





## GLOSSARY OF TERMS

### Funding Source Descriptions

**CIT - Capital Improvement Tax:** Funds derived from a 1.5 millage levy on local property. Revenues may be used for payment of principal and interest on COPS, for purchase of new and replacement equipment; for maintenance of existing facilities; rental and leasing of educational facilities and sites; purchase of new and replacement school buses; project management and for construction and remodeling of new or existing facilities. Based on 2017 legislation, a portion of the funds derived from the capital improvement millage may be distributed to eligible charter schools to pay for capital needs including but not limited to construction, vehicle purchases, and real property acquisition.

**COPS - Certificates of Participation:** These funds are not a source of revenue but the proceeds of a twenty-five-year loan against future property tax revenues. Funds may be used to remodel, renovate or replace existing schools and acquire land and construct additional schools.

**CSR - Class Size Reduction:** The voter approved constitutional amendment placed the responsibility for providing the necessary operating and capital funds required on the Legislature. The Class Size Reduction Capital Outlay program was established to provide funds to eligible public school districts for capital outlay purposes to reduce class size or for any lawful capital outlay purpose if the class size maximum had been met. In fiscal year 2000, the district received \$147.7 million from this program.

**IMPACT - School Impact Fees:** Florida Statutes direct local governments to make efficient and adequate provisions for schools. Impact fees represent a total or partial reimbursement for the cost of additional facilities or services necessary as a result of the new development. Funds can only be used to pay for capital expenditures resulting from student growth (i.e. relief schools).

**QSCB - Qualified School Construction Bonds:** QSCBs are financial instruments that provide a subsidy in the form of a tax credit to a bank or other financial institution that holds the QSCBs. The tax revenues are made available by the federal government to help fund school construction, rehabilitation, repair and land acquisition. These bonds were authorized by the federal government through the American Recovery and Reinvestment Act (ARRA) of 2009.

**SIT - School Infrastructure Thrift Award:** The SIT program provided incentive grants to districts for savings realized through functional and frugal school construction. These awards were funded by the Educational Enhancement (Lottery) Trust Fund. The district received a total of \$22.2 million for qualifying capital expenses.

## Common Terms by OCPS Facilities

**AE - Architect/ Engineer**

**BAS - Building Automation System**

**BIC - Ball-in-court**

**BOS - Bill of Sale:** Utility providers may require a sketch, legal description, and / or a bill of sale (documentation of sale of transfer of goods) for infrastructure improvements performed by the construction contractor.

**CCD - Construction Change Directive**

**CCTV - Closed Circuit Television**

**CE - Capacity Enhancement:** Permanent classroom addition at campuses with long term needs with no forecasted alternative for relief.

**CFI - Certificate of Final Inspection**

**CM - Construction Manager**

**CO - Change Order**

**CR - Contingency Request:** GMP contract amendments include not-to-exceed values for Contractor's Contingency and Owner's Contingency. Both require Owner approval prior to use.

**DX - Direct Expansion:** Direct expansion cooling is a type of refrigerant based HVAC system.

**ES - Elementary School**

**FE - Functional Equity:** Provision of functional core spaces (to meet current prototype design) to remedy program deficiencies on existing campuses.

**FISH - Florida Inventory of School Houses:** The Florida Department of Education maintains a central database of information for all educational and non-instructional facilities throughout the state.

**FY - Fiscal Year**

**GC - General Contractor**

**GMP - Guaranteed Maximum Price**

**GR - General Requirements:** GMP contract amendments include not-to-exceed values for Contractor reimbursable expenses that are not directly related to the construction cost of the work.

**HS - High School**

## Common Terms by OCPS Facilities

**HVAC - Heating, Ventilation, and Air Conditioning**

**IDF - Intermediate Distribution Frame:** IDF rooms are utilized for secondary distribution of networking systems throughout the facility.

**INT - Intermediate:** Projects with construction costs between \$280,000 and \$2,000,000.

**LF – Linear Foot**

**LG - Large:** Projects with construction costs that exceed \$2,000,000.

**MDF - Main Distribution Frame:** MDF rooms are utilized for primary distribution of networking systems throughout the facility.

**MS - Middle School**

**NTP - Notice to Proceed**

**O&M - Operation and Maintenance**

**ODP - Owner Direct Purchase:** The ODP program allows the District to benefit from its tax-exempt status by directly purchasing materials from suppliers, thereby avoiding the sales tax that contractors purchasing the same materials would pay.

**PM TEAM - Program Management Team**

**REPL - Replacement**

**SERV - Service**

**SF - Square Foot**

**SM - Small:** Projects with construction costs less than \$280,000.

**SUBST - Substantial**

**SY - School Year**

**TBD - To Be Determined**

**TCO - Temporary Certificate of Occupancy**

**WIP - Work in Progress**

**Wt'd Age - Weighted Age:** The weighted age of a facility is the average number of years since construction or comprehensive renovation. When buildings on a campus have different ages, an average is determined using the net floor area as the weighting factor.